

# AM100

## Installation Guide

### Low-Profile Ultra-Slim Swingout Mount for Flat-Panels

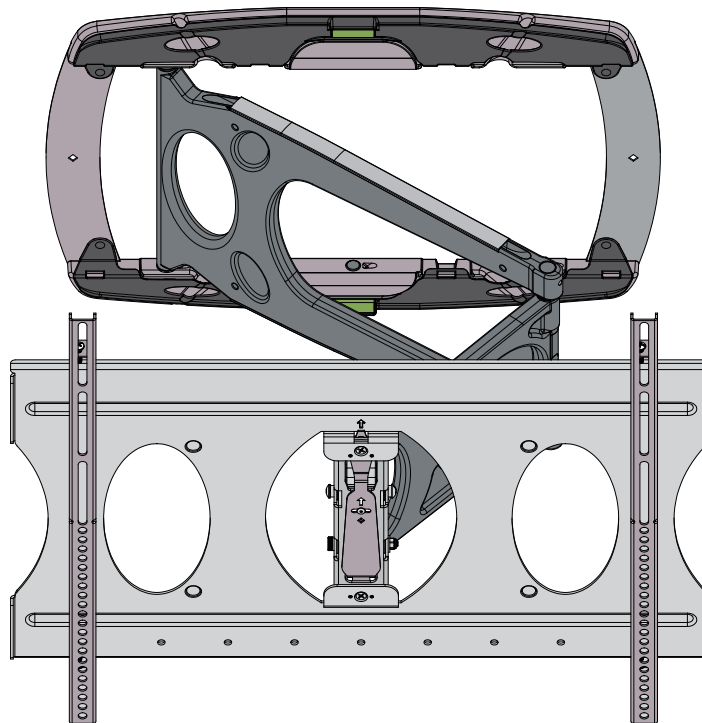

9531-100-001-0X REV A





#### Rated Capacity

**100 lbs / 45.5 kg**

Maximum Flat Panel Weight:

The wall structure must be capable of supporting at least four times the weight of the flat panel. If not, the wall structure must be reinforced.

#### Warning Statements



Prior to the installation of this product, the installation instructions must be read and completely understood. Keep these installation instructions in an easily accessible location for future reference.



Proper installation procedure by a qualified service technician must be followed, as outlined in these installation instructions. Failure to do so could result in property damage, serious personal injury, or even death.



Safety measures must be practiced at all times during the assembly of this product. Use proper safety equipment and tools for the assembly procedure to prevent personal injury.



Premier Mounts does not warrant against damage caused by the use of any Premier Mounts product for purposes other than those for which it was designed or damage caused by unauthorized attachments or modifications, and is not responsible for any damages, claims, demands, suits, actions or causes of action of whatever kind resulting from, arising out of or in any manner relating to any such use, attachments or modifications.



At least two qualified people should perform the assembly procedure. Personal injury and/or property damage can result from dropping or mishandling the flat panel.



If mounting to wall studs or ceiling studs, make sure that the mounting screws are anchored into the center of the wall studs or ceiling studs. Use of an edge-to-edge stud finder is recommended.



It is recommended that a maximum of 5/8" drywall be used when mounting to wooden studs.



Be aware of the mounting environment. If drilling and/or cutting into the mounting surface, always make sure that there are no electrical wires in wall. Cutting or drilling into an electrical line may cause serious personal injury.



Make sure there are no water or natural gas lines inside the wall where the mount is to be located. Cutting or drilling into a water or gas line may cause severe property damage or personal injury.



This product is intended for indoor use only. Use of this product outdoors could lead to product failure and/or serious personal injury.



Do not install near sources of high heat. Do not install on a structure that is prone to vibration, movement or chance of impact.



## INCLUDES

Wall Mount  
(Qty 1)

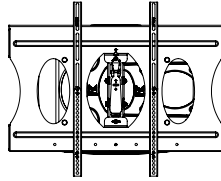

Template  
(Qty 1)

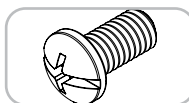
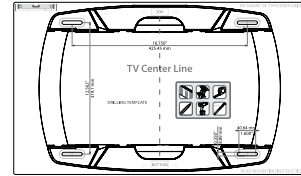

M6 x 16mm  
(Qty 4)

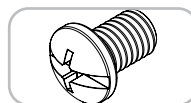

M8 x 16mm  
(Qty 4)

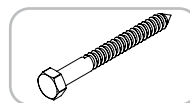

5/16 x 3 Lag  
(Qty 4)

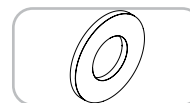

5/16 Washer  
(Qty 4)

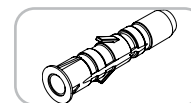

Twist-Resistance  
5/16 Anchor (Qty 4)

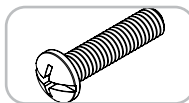

M6 x 25mm  
(Qty 4)

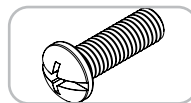

M8 x 25mm  
(Qty 4)

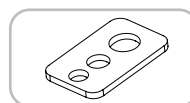

Universal 3-hole  
Washer (Qty 4)

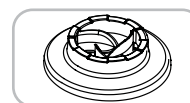

Universal Spacer  
M4-M8 (Qty 8)

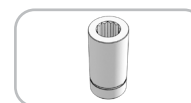

10mm Socket  
(Qty 1)



M2.5 Allen  
Key (Qty 1)



M4 Allen Key  
(Qty 1)



Depth Measuring  
Straw (Qty 1)

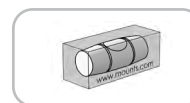

Green Level  
(Qty 1)

## TOOLS FOR INSTALLATION



Electronic Stud Finder

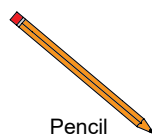

Pencil

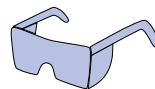

Protective Eyewear

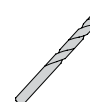

M6 or 1/4" Wood Drill Bit

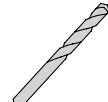

3/8" Concrete Drill Bit

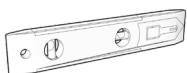

Leveler

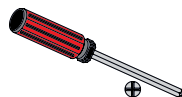

Phillips Head Screwdriver



13mm or 1/2" Socket

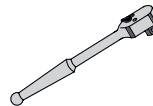

Socket Wrench



Portable Drill

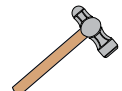

Hammer



### OPTIONAL: CHANGING THE DEFAULT SWINGOUT PIVOT POSITION

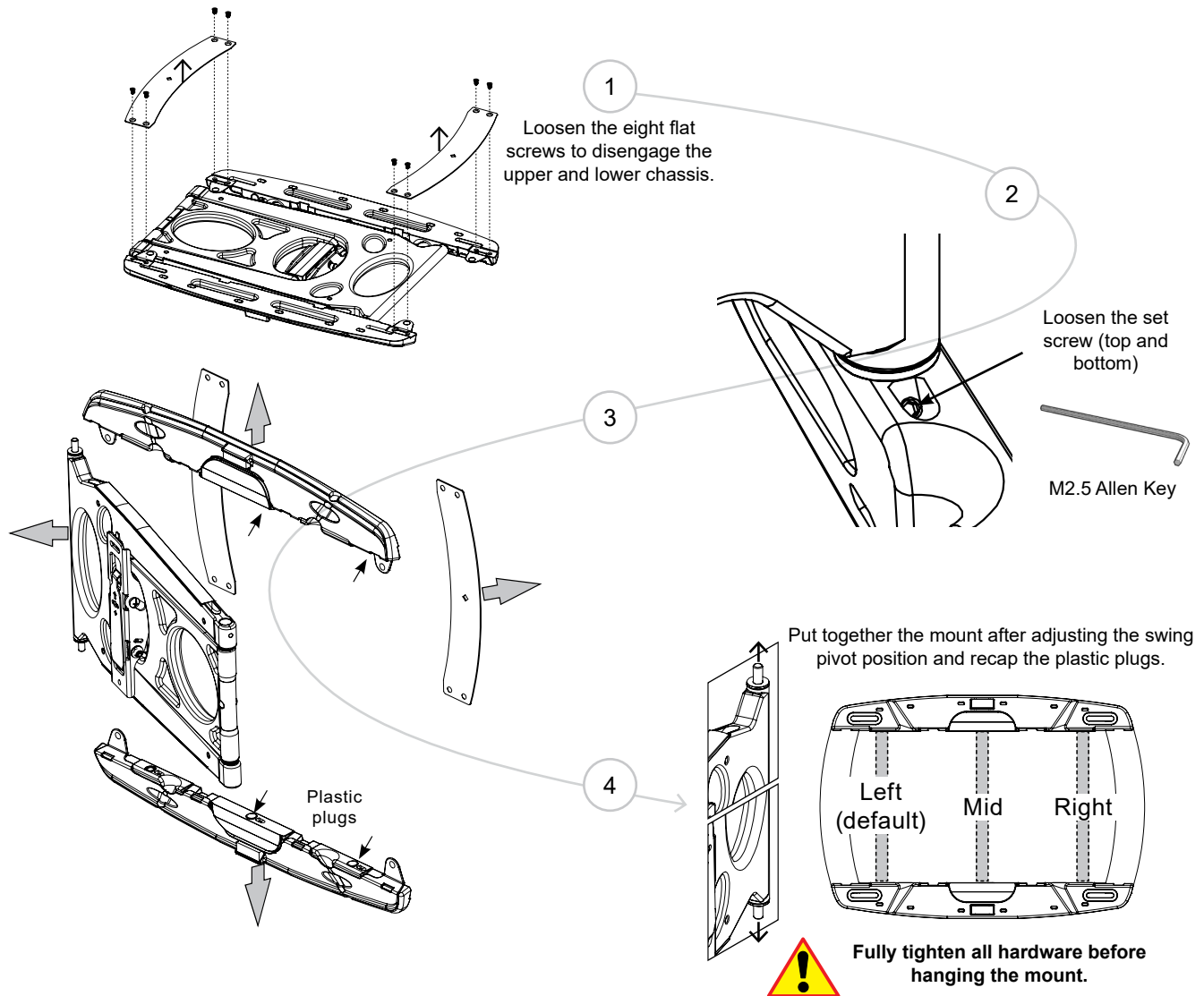

**Remove the plastic panel covers to access the mounting slots.**

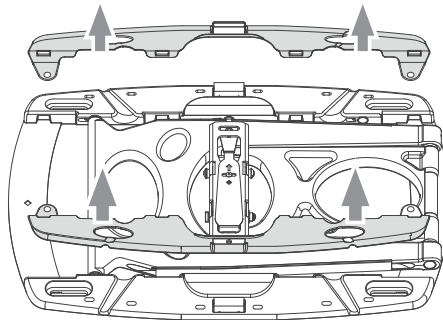

## WOOD APPLICATION

## CONCRETE APPLICATION

1

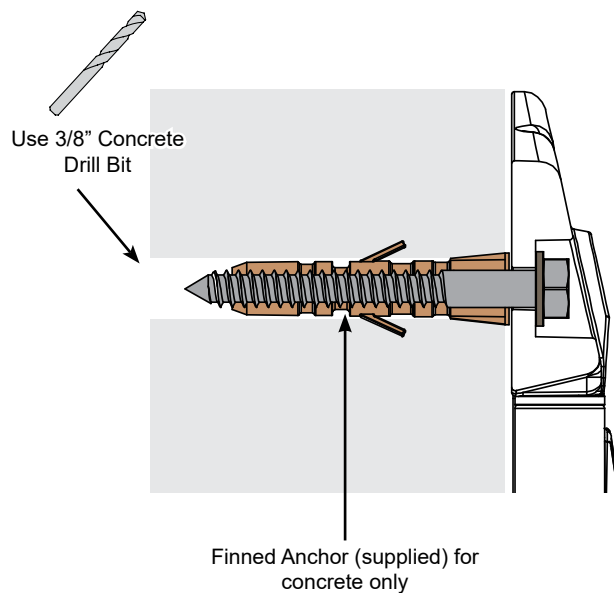
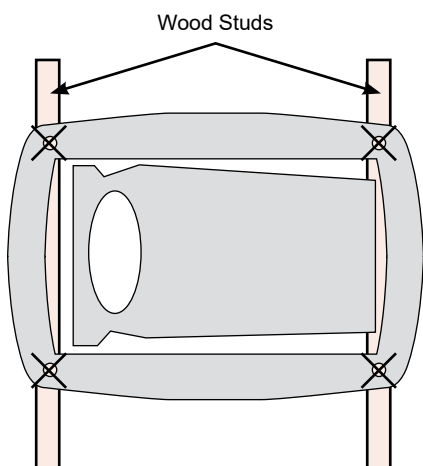

2

Position the template to the desired location.

Drill into 4 marked mounting points on the wall surface.

### Wood Application:

Use 1/4 inch drill bit

### Concrete Application:

Use 3/8 inch drill bit

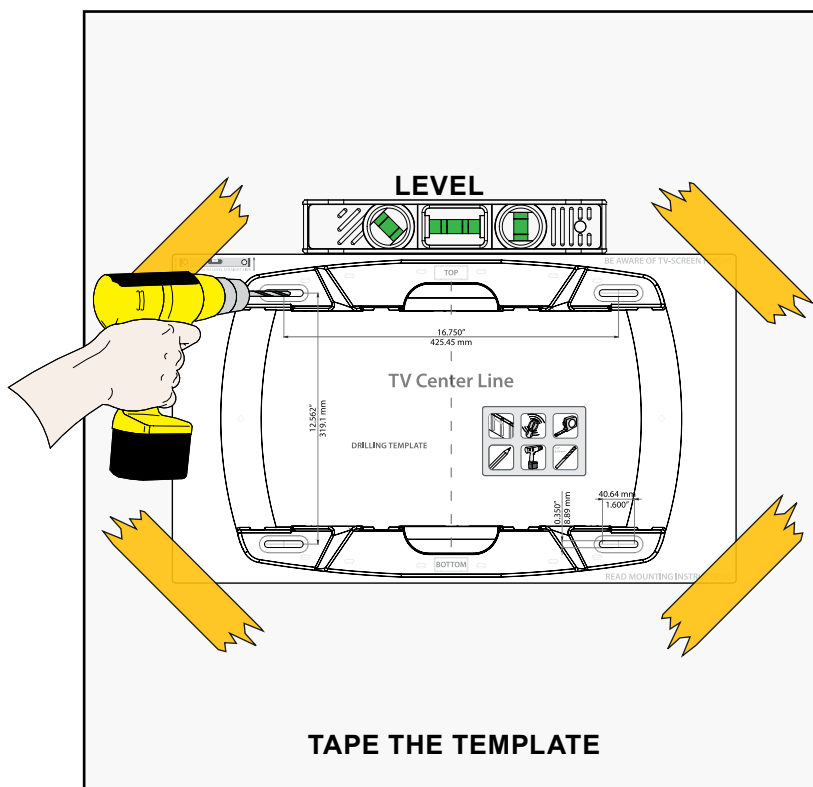

5

Confirm the placement of the mounting screws before bolting into place.

Use 13mm or 1/2"  
Socket

(4) 5/16" x 3" Hex Lag  
and (4) 5/16" Washers

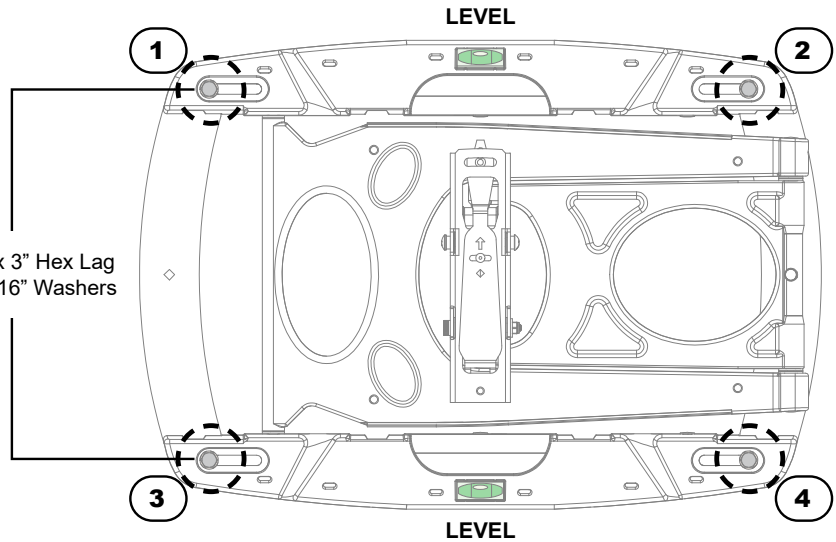

6

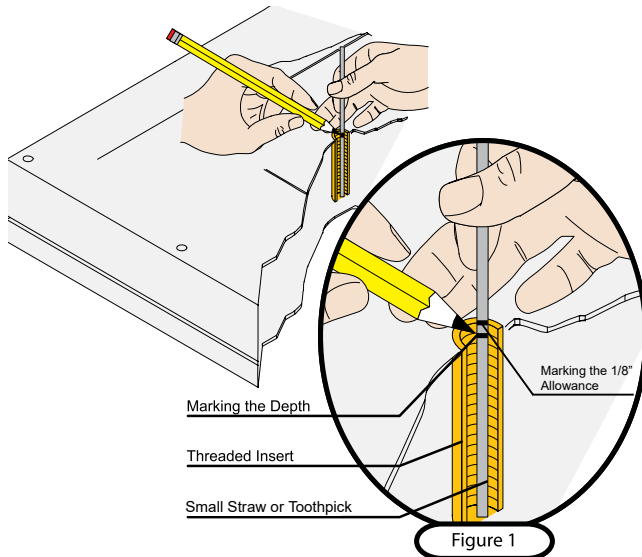

## Selecting the Mounting Hardware

- 1) Insert a small straw or toothpick into the threaded inserts found on the back of the flat-panel.
- 2) Use a pencil to mark the depth of the threaded insert on the small straw or toothpick.
- 3) Mark the straw or toothpick 1/8" above the depth of the threaded insert, as shown in Figure 1.
- 4) Insert the small straw or toothpick into the remaining threaded inserts to compare and verify their depth using the straw or toothpick's 1/8" allowance mark.
- 5) Locate the correct diameter screw for the threaded insert.



If the screw you selected is longer than the 1/8" allowance mark on the small straw or toothpick, as shown in Figure 2 and Figure 3, do not use this screw. The screw length must not bypass the mark.

- 6) Test each size of the screws provided.  
The correct screws should thread easily into the mounting point and not pull out when tension is applied.

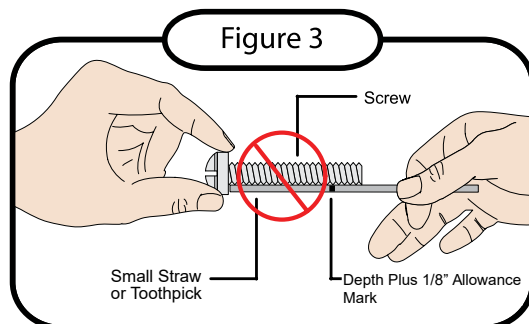
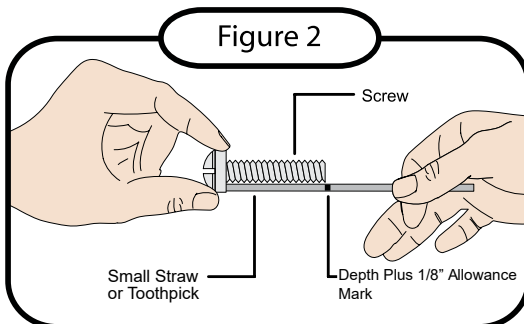

## INSTALL THE MOUNTING BRACKETS

7

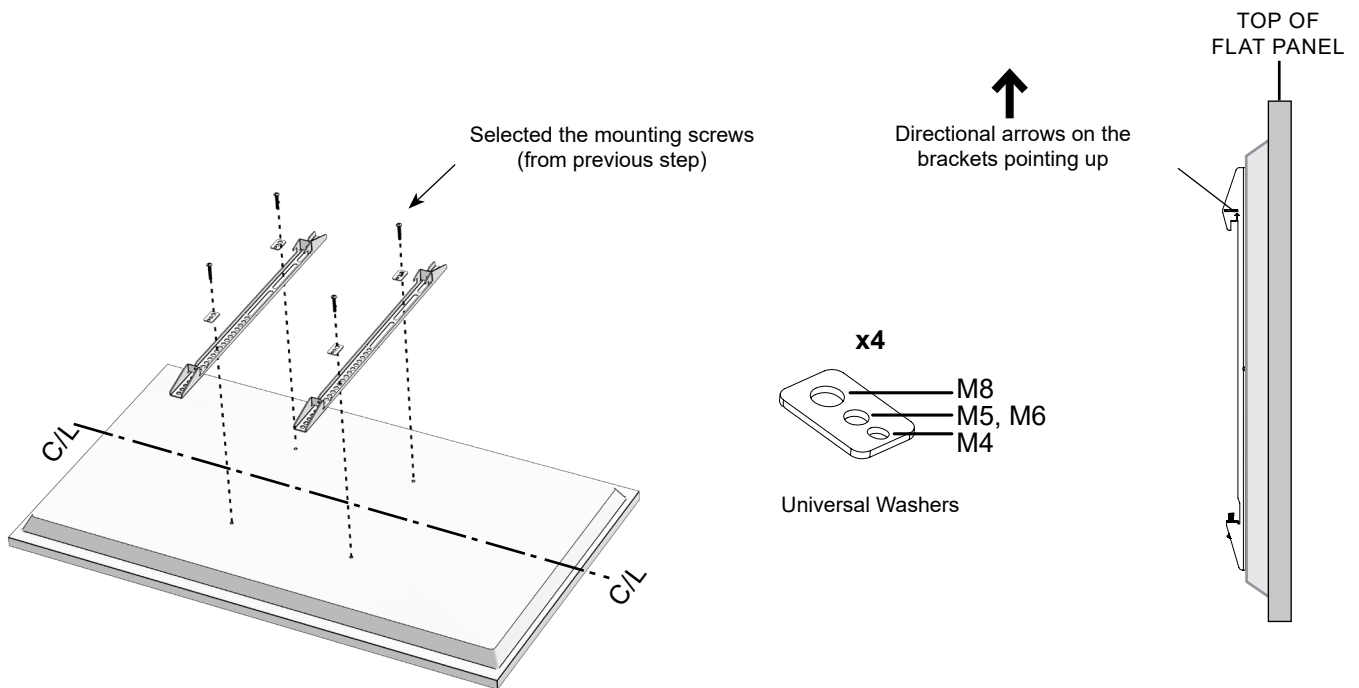

## USE ADDITIONAL UNIVERSAL SPACERS TO FILL UNEVEN GAPS

Longer screws length (commercially available) might  
be needed if using spacers.

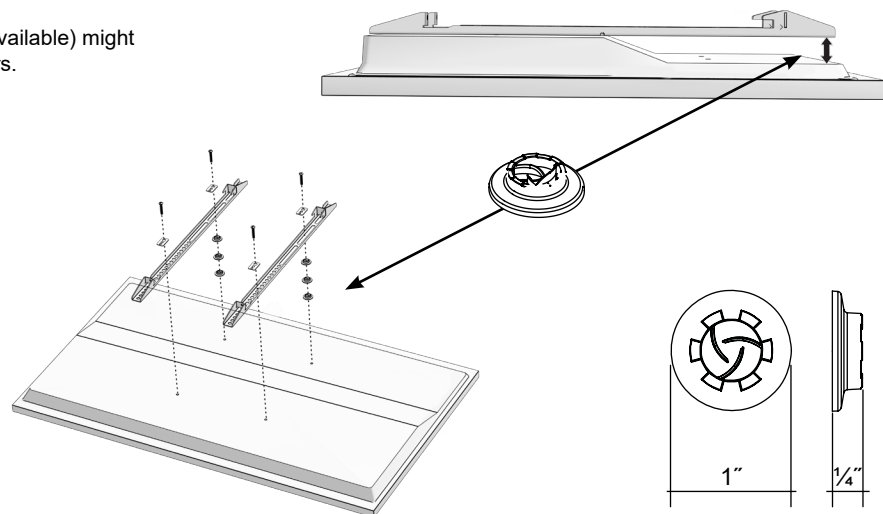

8

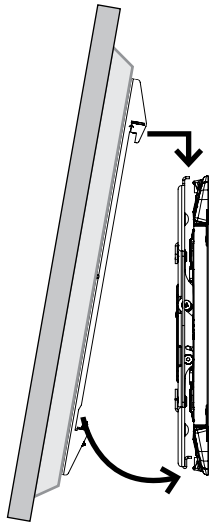

Place the display brackets on the wall plate and position them relative to the mount.

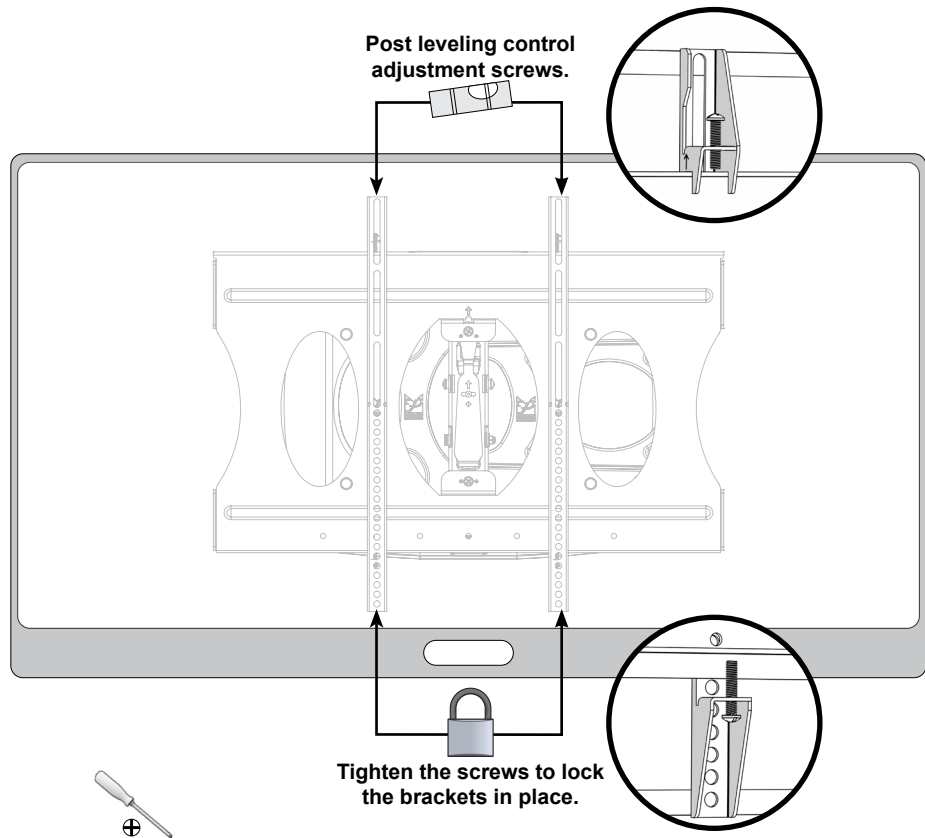

### OPTIONAL: TILT ADJUSTMENTS

9

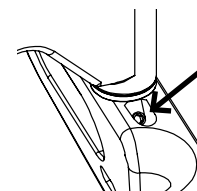
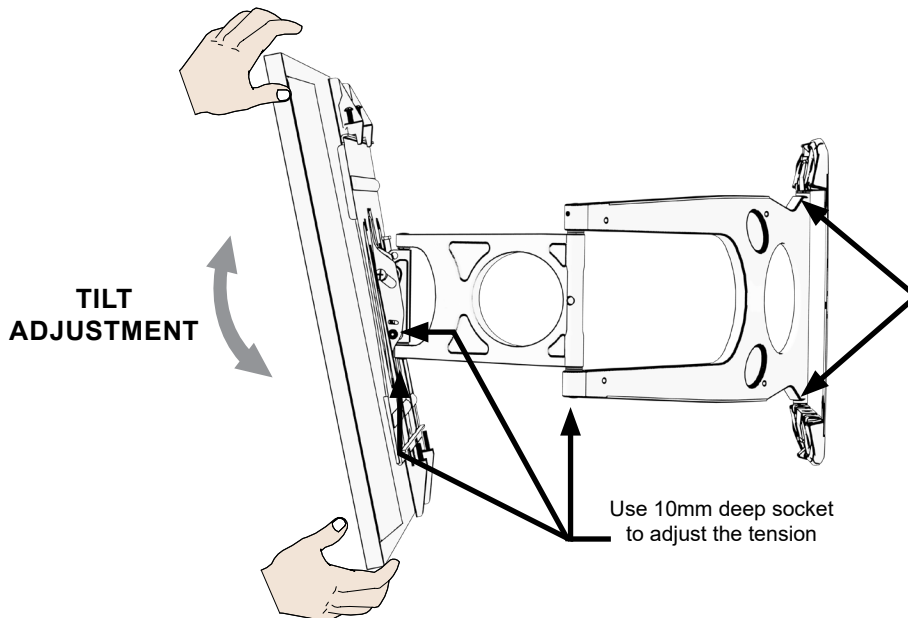

Use 2.5mm hex key to adjust the tension near the pivot.

Do not over tighten.



10

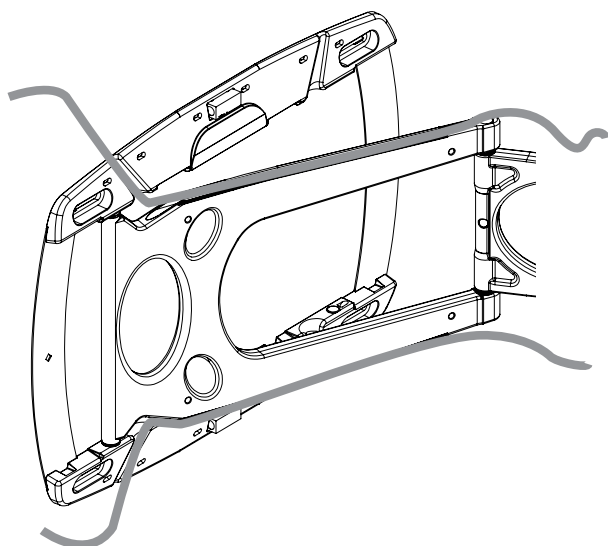

ROUTE POWER AND SIGNAL ALONG THE  
MOUNT

11

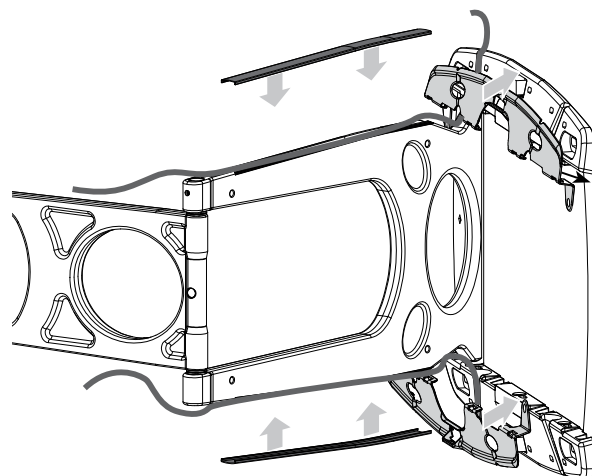

INSTALL THE CABLE COVERS AND  
MOUNTING COVERS

### SECONDARY POST LEVELING ADJUSTMENT

12

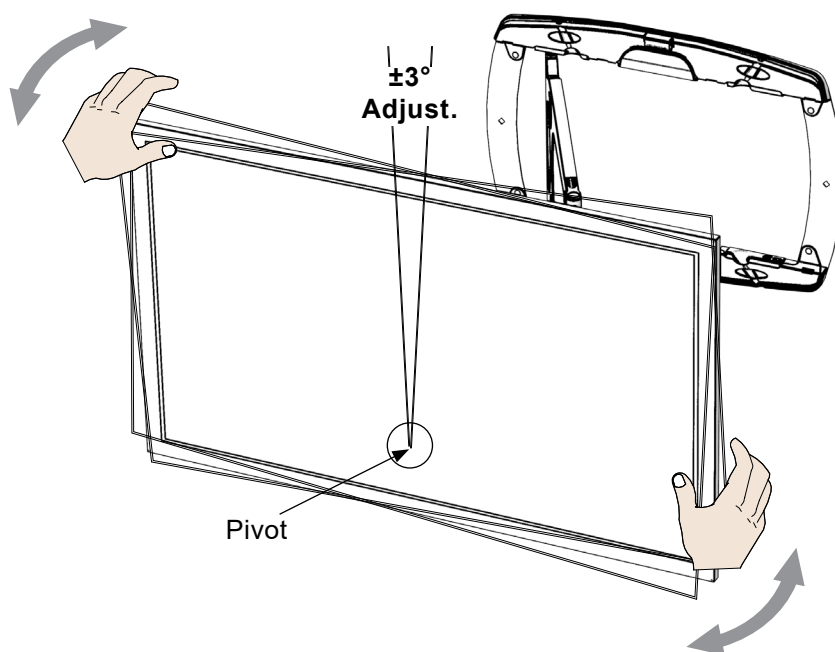

RETRACTED OR  
EXTENDED POSITION