

RTM-S

Installation Guide

Rotating Tilt Mount for Dual-Pole Cart and Stand

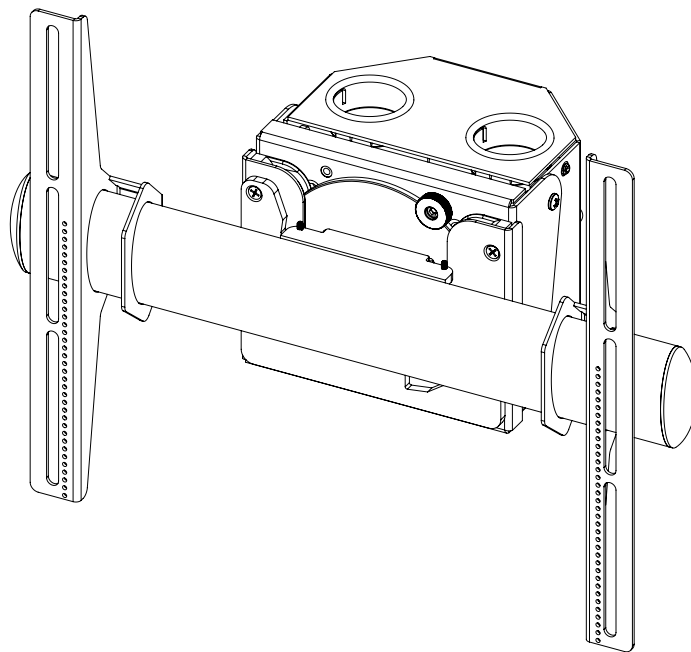

9531-009-021-0X REV A



Rated Capacity

125 lbs / 56.7 kg

Maximum Flat Panel Weight:

Warning Statements



Premier Mounts does not warrant against damage caused by the use of any Premier Mounts product for purposes other than those for which it was designed or damage caused by unauthorized attachments or modifications, and is not responsible for any damages, claims, demands, suit actions or causes of action of whatever kind resulting from, arising out of or in any manner relating to any such use, attachments or modifications.



The floor must be capable of supporting at least four times the weight of the display. If not; the floor structure must be reinforced. Proper installation procedure by a qualified service technician, as outlined in the installation instructions, must be adhered to. Failure to do so could result in serious personal injury, or even death.



Safety measures must be practiced at all times during the assembly of this product. Use proper safety gear and tools for the assembly procedure to prevent personal injury.



Prior to the installation of this product, the assembly instructions should be read and completely understood. The assembly instructions must be read to prevent personal injury and property damage. Keep these assembly instructions in an easily accessible location for future reference.



Do not install on a structure that is prone to vibration, movement or chance of impact. Failure to do so could result in damage to the display and/or damage to the mounting surface.



Do not install near heater, fire place, direct sunlight, air conditioning or any other source of direct heat energy. Failure to do so may result in damage to the display and could increase the risk of fire.



At least two qualified people should perform the assembly procedure. Injury and/or damage can result from dropping or mishandling the display.



INCLUDES:

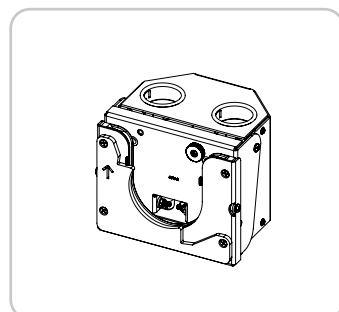

Mounting Block
(Qty.1)



M4 x 16mm
Screw (Qty.4)



M6 x 16mm
Screw (Qty.4)



M8 x 16mm
Screw (Qty.4)

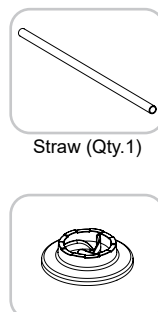

Straw (Qty.1)



M6 x 12mm Button
Security (Qty.1)



M4 x 25mm
Screw (Qty.4)



M6 x 25mm
Screw (Qty.4)



M8 x 25mm
Screw (Qty.4)

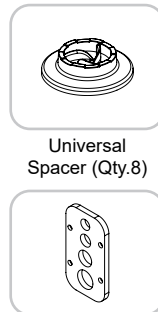

Universal
Spacer (Qty.8)



M6 Split-Lock
Washer (Qty.1)

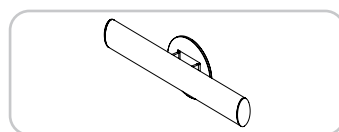

Cross Bar (Qty.1)



M4 x 30mm
Screw (Qty.4)



M6 x 30mm
Screw (Qty.4)

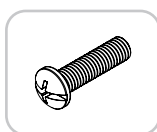

M8 x 30mm
Screw (Qty.4)

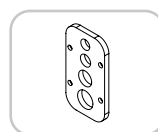

Griplate™ (Qty.4)

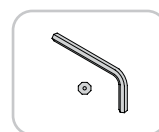

M5 Security Allen
Key (Qty.1)

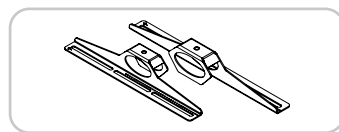

Mounting Bracket (Qty.2)

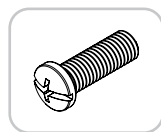

M10 x 30mm
Screw (Qty.4)



5/32" Allen Key
(Qty.1)

1

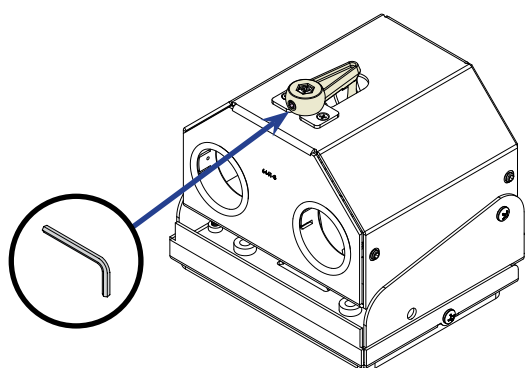

Loosen the set screw to remove the
crank from the mounting block.

2

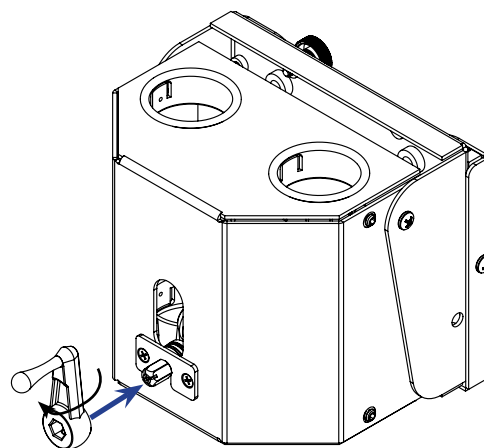

Reinstall the crank at reverse position
then tighten the set screw.

3

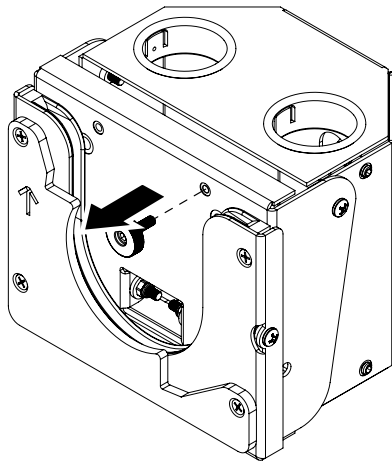

Remove the M6 Knurl Knob from the mounting block and place it aside.

4

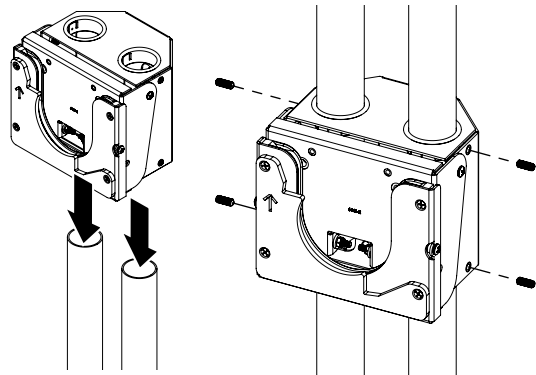

1. Slide the mounting block over the tubes.
2. Tighten the four (4) pre-installed M8 set screws using the supplied 5/32" Allen Key.

Selecting the Mounting Hardware

5

1. Insert a small straw or toothpick into the threaded inserts found on the back of the flat-panel.
2. Use a pencil to mark the depth of the threaded insert on the small straw or toothpick.
3. Mark the straw or toothpick 1/8" above the depth of the threaded insert, as shown in Figure 1.
4. Insert the small straw or toothpick into the remaining threaded inserts to compare and verify their depth using the straw or toothpick's 1/8" allowance mark.
5. Locate the correct diameter screw for the threaded insert.
6. Test each size of the screws provided. The correct screws should thread easily into the mounting point and not pull out when tension is applied.



If the screw you selected is longer than the 1/8" allowance mark on the small straw or toothpick, as shown in Figure 2 and Figure 3, do not use this screw. The screw length must not bypass the mark.

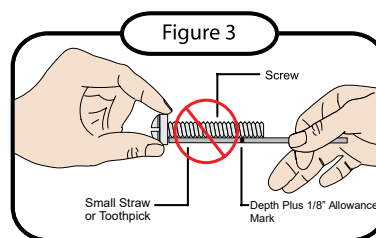
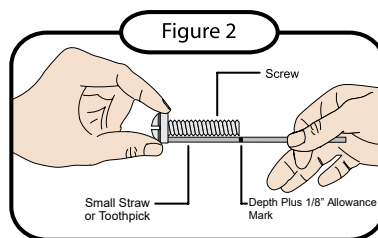
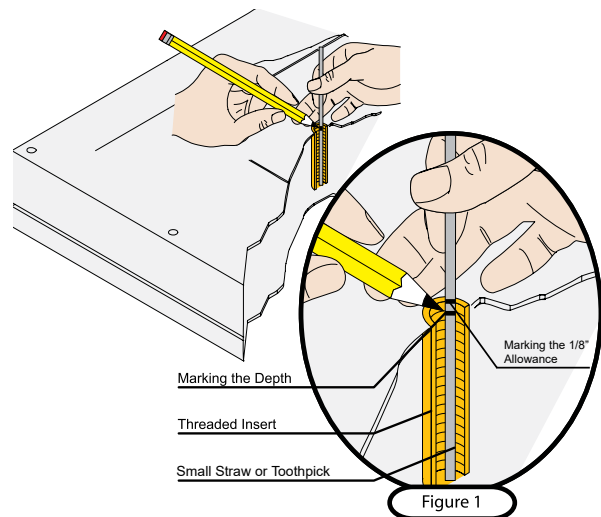

6

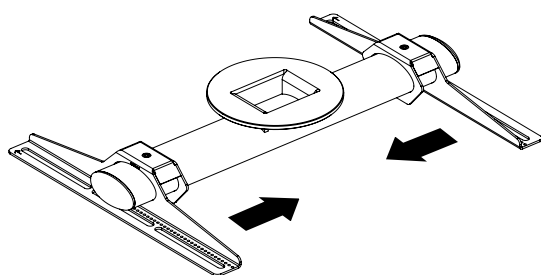

Insert the mounting brackets into the crossbar.

Reverse the direction of the mounting brackets for VESA 300 or lower.

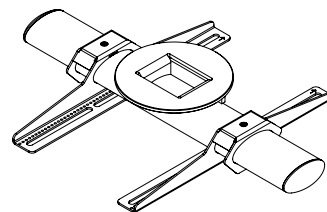

7

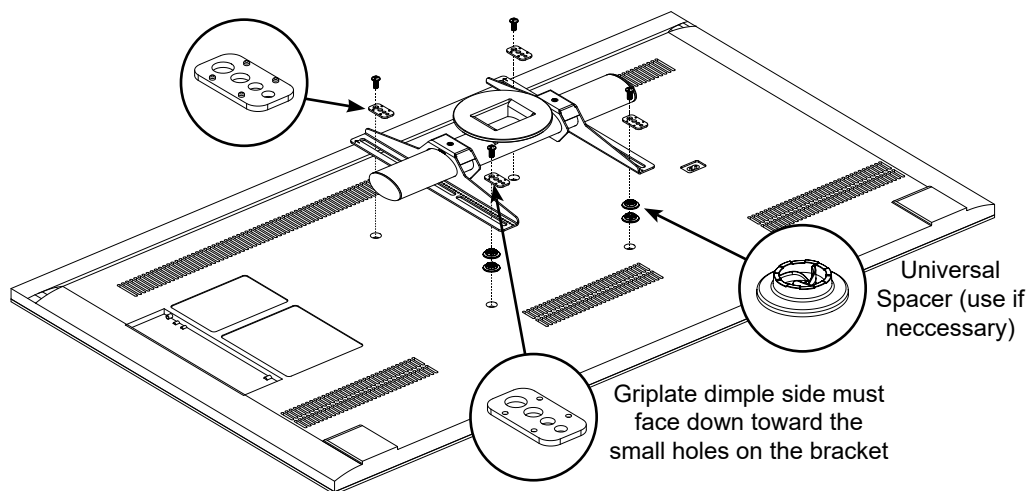

Align the brackets to the display mounting holes. Use the depth measuring straw to determine the appropriate hardware. Use (4) M4, M6, or M8 screws depending on display and (4) Griplate™ (Universal Washer). Use Universal Spacer if necessary.

8

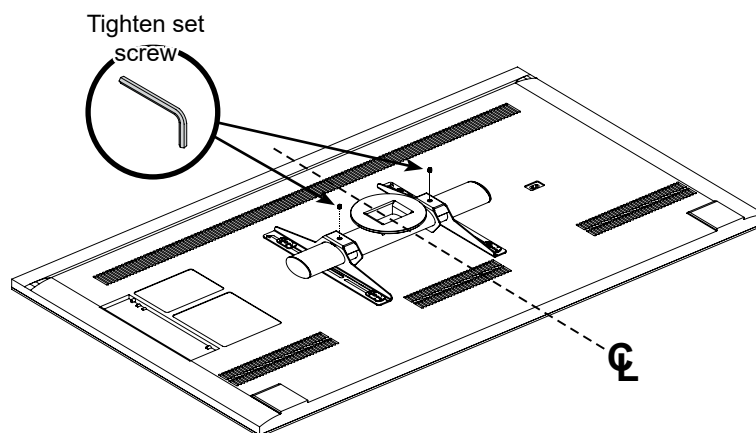

Center the crossbar to the display panel. Tighten the set screws using the 5/32" Allen Key to secure the brackets.

9

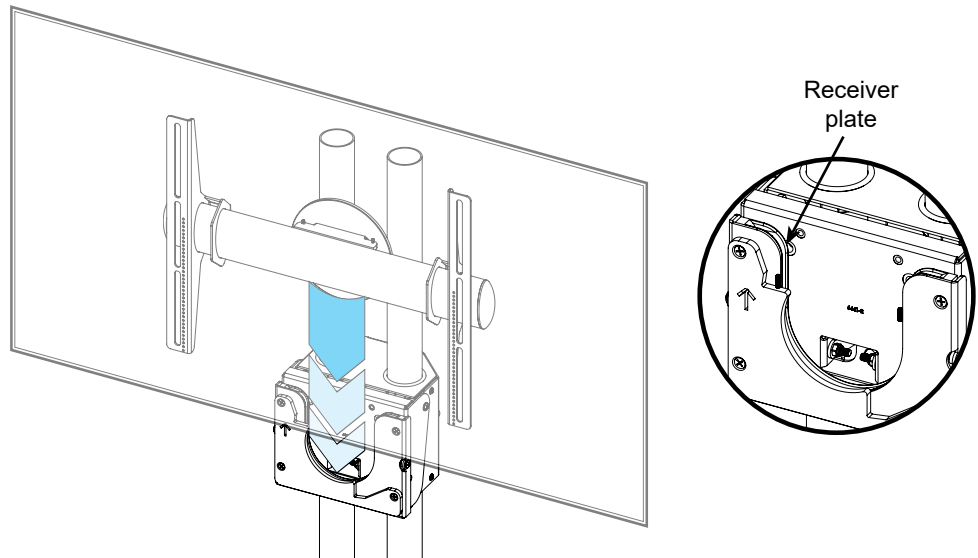

Lift up the display panel and insert the axle of the crossbar into the receiver plate.

10

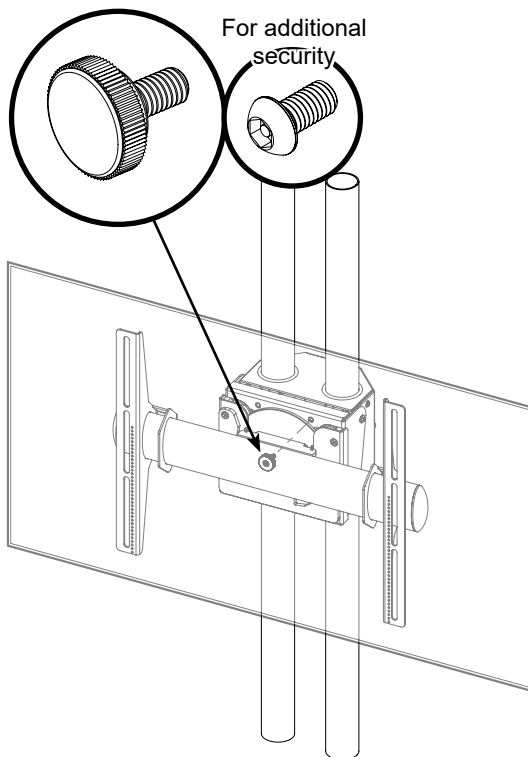

Install the M6 knurl knob or M6 security screw to secure the crossbar from dislodging.

11

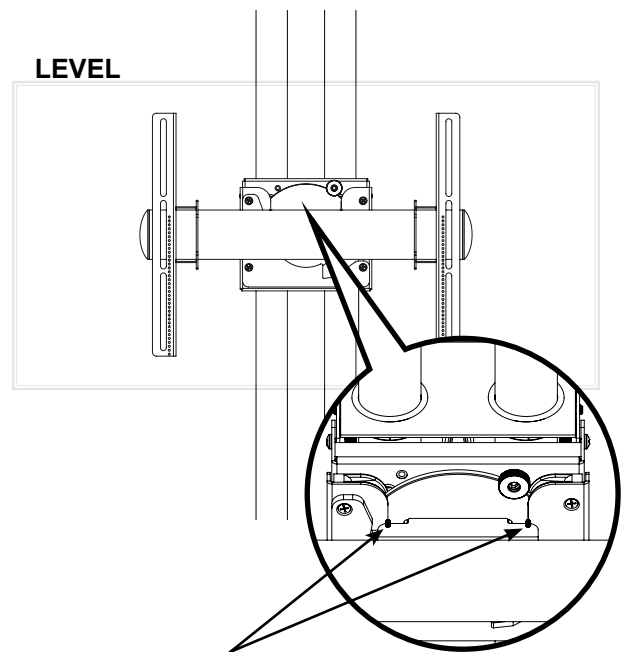

Adjust the level of the display arms by loosen/tighten (2) M4 x 8mm Set Screw.

12

OPTIONAL:

To stiffen the rotation, tighten the two screws located on the side of the mounting block.

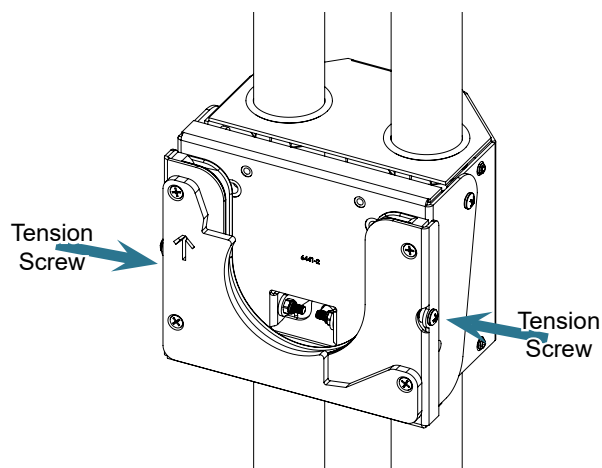

13

OPTIONAL:

The mount can rotate 90 degree, landscape to portrait, clockwise or counter-clockwise.

To change the rotation, remove the (3) screws holding the rotational limiter, flip the part, and reinstall in opposite direction, as shown in figure 1 & 2.

Figure 1

Rotational limiter plate

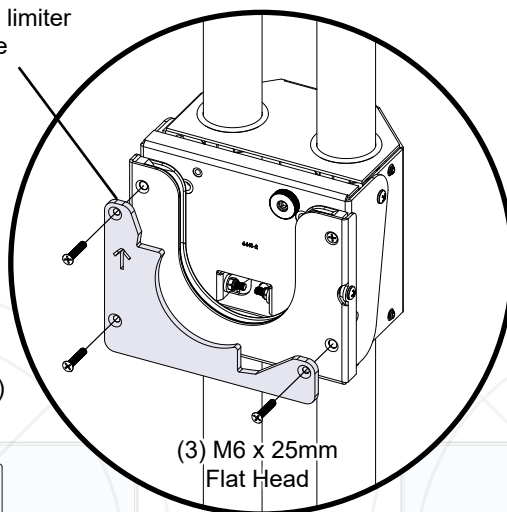

Reverse rotation
(Counter-Clockwise)

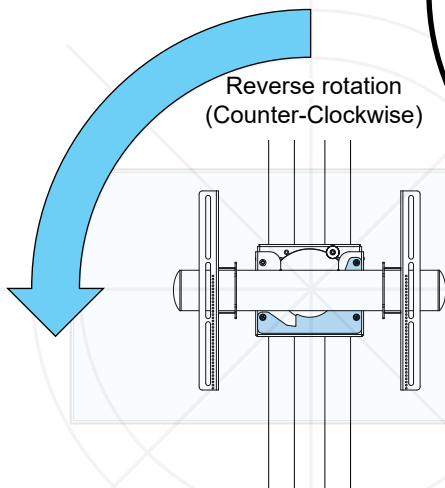

Figure 2

Default rotation
(Clockwise)

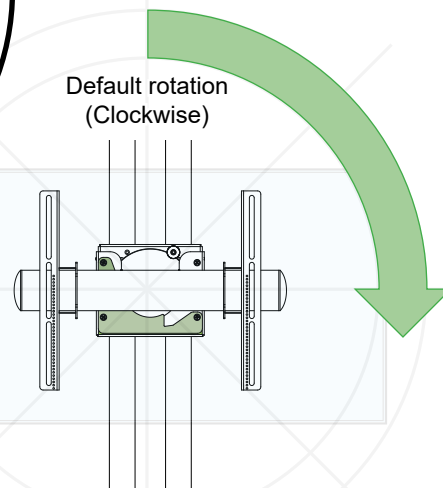

Figure 3