



INSTALLATION INSTRUCTIONS

Product

7160-1566/7170-0848-XX - Standard console
7160-1566-01/7170-0864-XX - Console with Printer mount

Revision

A

Form

INST-1008

Printing Spec: PS-005

2021+ Chevrolet Tahoe PPV/SSV Widebody Console

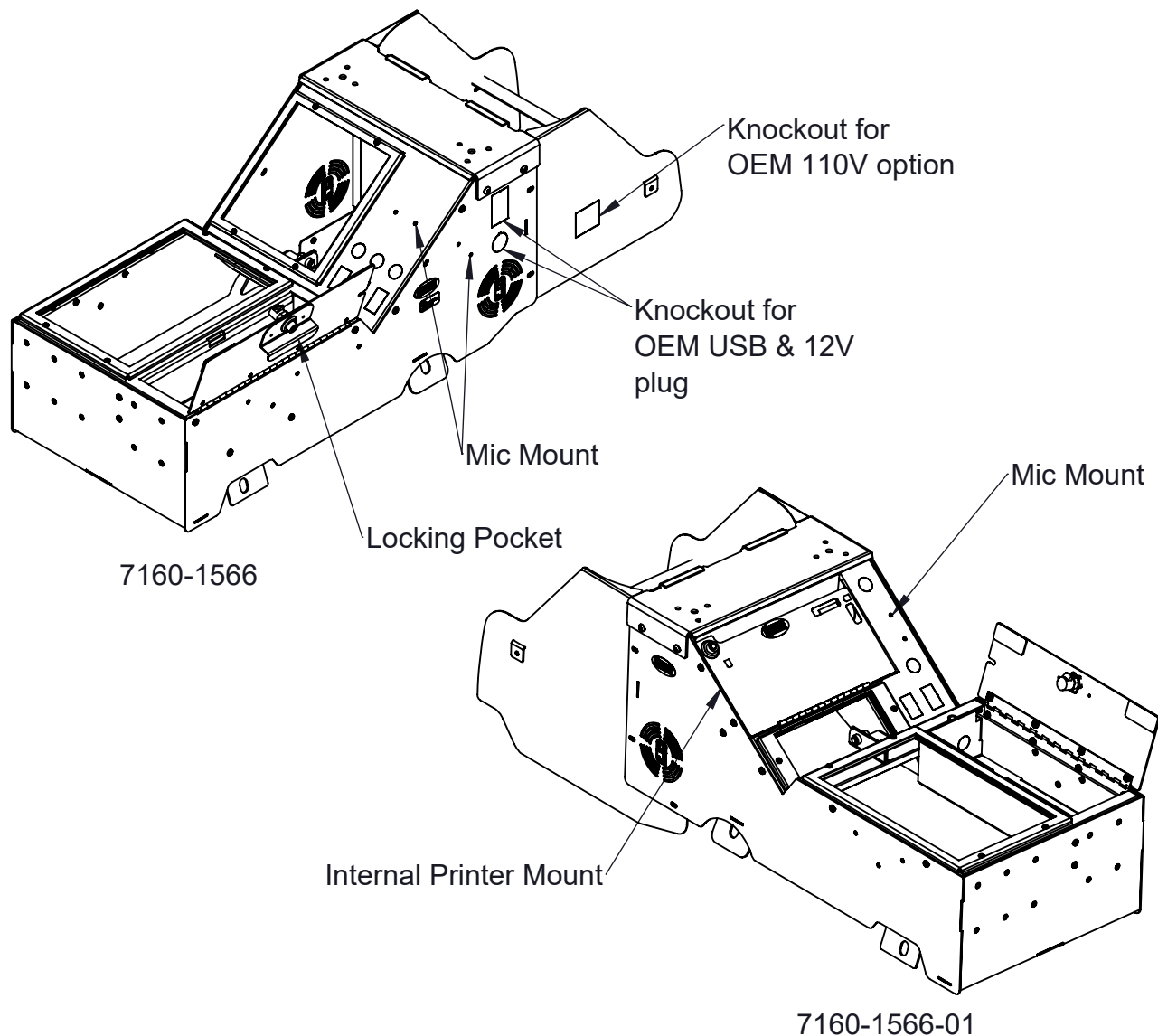

Product Mounting Disclaimer

Gamber-Johnson is not liable under any theory of contract or tort law for any loss, damage, personal injury, special, incidental or consequential damages for personal injury or other damage of any nature arising directly or indirectly as a result of the improper installation or use of its products in vehicle or any other application. In order to safely install and use Gamber-Johnson products full consideration of vehicle occupants, vehicle systems (i.e., the location of fuel lines, brake lines, electrical, drive train or other systems), air-bags and other safety equipment is required. Gamber-Johnson specifically disclaims any responsibility for the improper use or installation of its products not consistent with original vehicle manufactures specifications and recommendations, Gamber-Johnson product instruction sheets, or workmanship standards as endorsed through the Gamber-Johnson Certified Installer Program.

© Copyright 2020 Gamber-Johnson, LLC

If you need assistance or have questions, call Gamber-Johnson at 1-800-456-6868

ITEM	QTY	PartNo	DESCRIPTION
1	1	19578	CONSOLE - 2021+ TAHOE WIDEBODY
2	1	18103	F150 REAR AREA BRACKET
3	1	18104	F150 SLOPED AREA BRACKET
4	1	17080	HINGE
5	1	18116	F150 CONSOLE LID
6	1	18125	F150 REAR OPENING HOLD DOWN FRAME
7	1	18126	F150 SLOPED AREA HOLD DOWN
8	2	14710	1.00 X 2.50 X .062 THK PORON PAD
9	1	11893	LOCK - DIRAK 264-9006
10	2	9000-0043	DUAL LOCK - .50 WIDE, BLACK, HIGH DENSITY SIDE
11	1	9000-0046	DUAL LOCK - .50 WIDE, BLACK, LOW DENSITY SIDE
12	2	19594	LEG - FRONT MOUNT, 2021 TAHOE WIDEBODY CONSOLE
13	1	19605	POCKET - 2021 TAHOE WIDEBODY CONSOLE
14	1	19606	TOP PLATE - 2021 TAHOE WIDEBODY CONSOLE
15	1	19620	COVER WING - 2021+ TAHOE CONSOLE DRIVER SIDE
16	1	19665	COVER PLATE - 2021+ TAHOE CONSOLE PASSENGER SIDE
17	1	19716	BRACE - 14" WIDE CONSOLE WING SUPPORT
25	1	INST-1008	INSTRUCTION SHEET - 2021+ CHEVROLET TAHOE WIDEBODY CONSOLE
28	2	14500	EDGE TRIM - .18 GAP, BLACK RUBBER
29	4	3130-0052	3/8 Flat Washer -FS-014

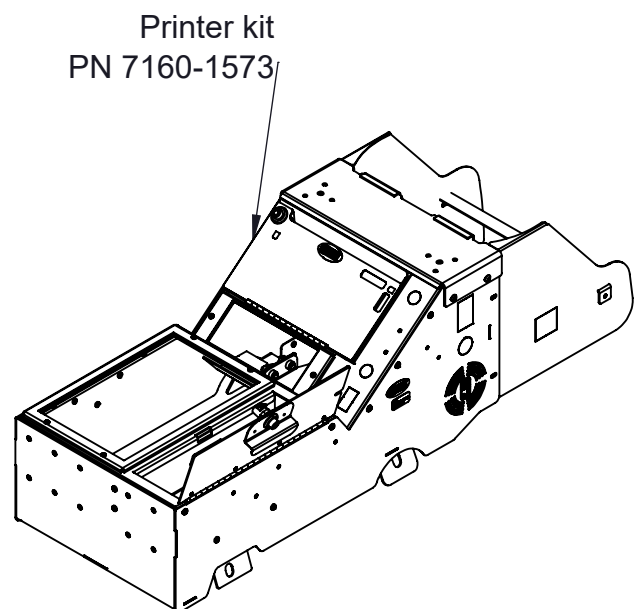
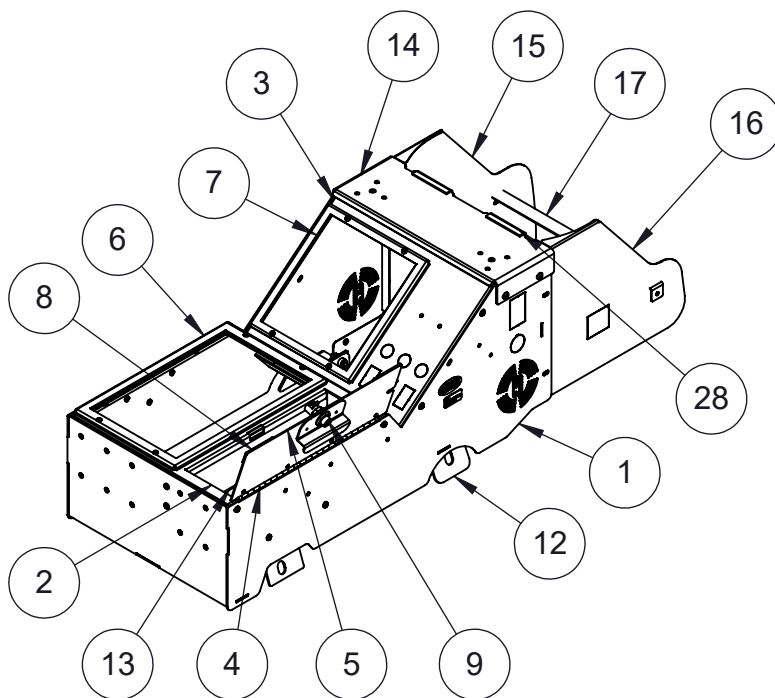

Install

1. Remove OEM center seat, with 18MM socket. after more 4 bolts remove center seat, (keep bolt for reuse) disconnect any electrical harness.



Fig. 1

2. Relocating OEM USB & 12V.

*First remove the lower center trim by loosen the bolt on the driver side with a 7MM socket. then pull on the trim straight back (trim is hold on by clips)

*trim that's holding the USB & 12V housing can be pull out in the same manner.

*Disconnect the harness



Fig. 2

3. While trim is loose, to gain more length in the harness. behind the trim we can pop out the push in clips that holding harness then reinstall the center trim pieces. Install the USB & 12V housing on passenger side of console.



Fig. 3

4. With center seat removed, place Widebody console in place and align 4 mounting holes on the console with OEM seat holes.

*Before installing oem seat bolt, attach driver side wings to the console (with provided #10 hardware) first to ease the install.



Fig. 4

5. With the wing in place, the console can be attached to vehicle with 4 OEM seat bolt (Blue Arrow). Torque bolt to OEM spec.

*Front 2 legs in the console can be loosen for adjustment if needed. Tighten down if loosen

6. with console in place the passenger side wings can be installed on to console and the wing brace can be installed as well with provided #10 hardware.

*If vehicle has the front 110V plug, it can be installed on knockout on the passenger side wing.



Fig. 5

7. With that console install is complete and can outfitted with required equipment.



Fig. 6

Optional Equipment:

7160-1573 Printer mount can added to 7160-1566 console.

*when adding the Printer mount you will loose 5" of mounting space.

