



INSTALLATION INSTRUCTIONS

Product

7160-1133: FORD UTILITY INTERCEPTOR PARTITION

Revision

REV. A

Form

INST-830

Printing Spec: PS-001

1. SLIDE AND LEAN THE FRONT DRIVER AND PASSENGER SEATS FORWARD.
2. REMOVE BOTH REAR SEAT BOLTS FROM EACH SEAT AND SLIDE THE APPROPRIATE FOOT WELL BRACKETS UNDERNEATH THE CORRESPONDING SEAT TRACK. LOOSELY REINSTALL THE MOUNTING BOLTS.
3. LOOSELY MOUNT A LOWER TUBE WELDMENT TO EACH FOOT WELL BRACKET USING THE PROVIDED 3/8-16 HEX BOLT, WASHERS, AND NUT (FIGURE 01).
4. REMOVE THE REAR GRAB HANDLES FROM THE B-PILLARS AND LOOSELY ATTACH THE CORRELATING B-PILLAR BRACKETS.

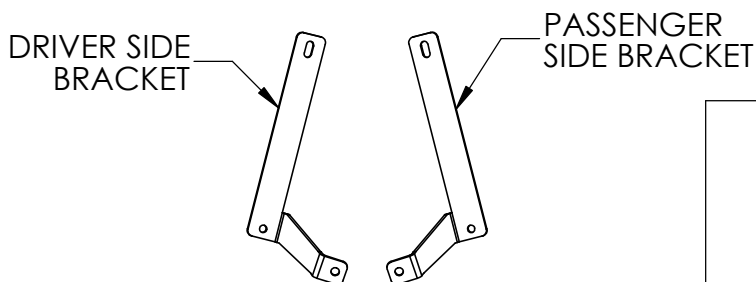
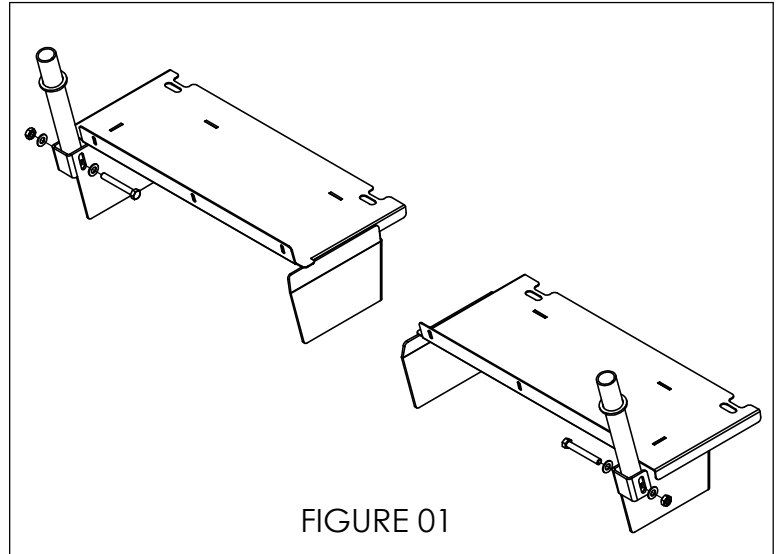

5. ATTACH THE FLAT PANEL TO THE PARTITION USING #10-32 CARRIAGE BOLTS AND KEEPER NUTS PROVIDED (FIGURE 02).

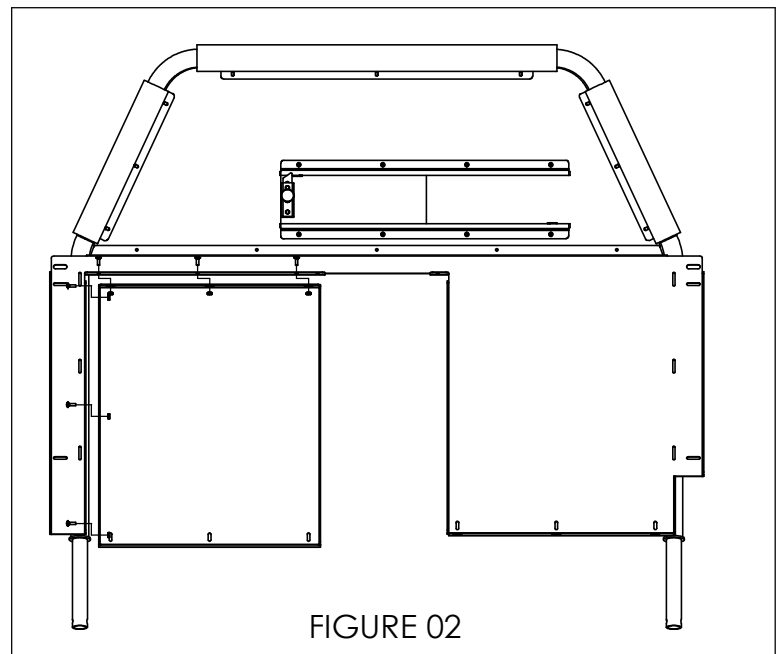

Product Mounting Disclaimer

Gamber-Johnson is not liable under any theory of contract or tort law for any loss, damage, personal injury, special, incidental or consequential damages for personal injury or other damage of any nature arising directly or indirectly as a result of the improper installation or use of its products in vehicle or any other application. In order to safely install and use Gamber-Johnson products full consideration of vehicle occupants, vehicle systems (i.e., the location of fuel lines, brakes lines, electrical, drive train or other systems), air-bags and other safety equipment is required. Gamber-Johnson specifically disclaims any responsibility for the improper use or installation of its products not consistent with the original vehicle manufactures specifications and recommendations, Gamber-Johnson product instruction sheets, or workmanship standards as endorsed through the Gamber-Johnson Certified Installer Program.

© Copyright 2019 Gamber-Johnson, LLC

If you need assistance or have questions, call Gamber-Johnson at 1-800-456-6868

6. INSERT THE MAIN WELDMENT INTO THE VEHICLE WITH THE SLIDING WINDOW KNOB FACING TOWARD THE FRONT SEATS. ALIGN THE MAIN WELDMENT WITH THE LOWER TUBE WELDMENTS AND LOWER IT ONTO THEM (FIGURE 03).
7. TILT THE PARTITION FORWARD AND LOOSELY ATTACH TO THE B-PILLAR BRACKETS USING 5/16-18 HEX BOLTS, WASHERS, AND NUTS (FIGURE 03).
8. LOOSELY ATTACH FILLER PANELS TO THEIR RESPECTIVE LOCATIONS (FIGURE 03).
9. ENSURE THE PARTITION IS CENTERED WITHIN THE VEHICLE AND MITIGATE ANY GAP BETWEEN THE VEHICLE HEADLINER AND UPPER PARTITION FRAME.
10. FULLY TIGHTEN THE REAR SEAT BOLTS, B-PILLAR BRACKETS, FILLER PLATES, AND LOWER TUBE WELDMENT HARDWARE TO SECURE THE PARTITION POSITION.
11. LOOSELY ATTACH THE CENTER EXTENSION TO THE RECESSED PANEL, AS SHOWN IN FIGURE 04, AND FASTEN TO THE MAIN ASSEMBLY USING #10-32 CARRIAGE BOLTS AND KEEPER NUTS.
*NOTE: THE CENTER EXTENSION HAS A LASER KNOCK-OUT FOR THE OEM WIRE CHASE TUNNEL IF REQUIRED.
<PARA >
12. ATTACH CENTER ASSEMBLY TO THE MAIN WELDMENT USING #10-32 CARRIAGE BOLTS AND KEEPER NUTS (FIGURE 05).
13. FINALIZE ADJUSTMENTS AND TIGHTEN THE CENTER EXTENSION. ADD #10-32 HARDWARE TO SECURE THE CENTER EXTENSION TO THE FILLER PLATES AND FULLY TIGHTEN (FIGURE 06).

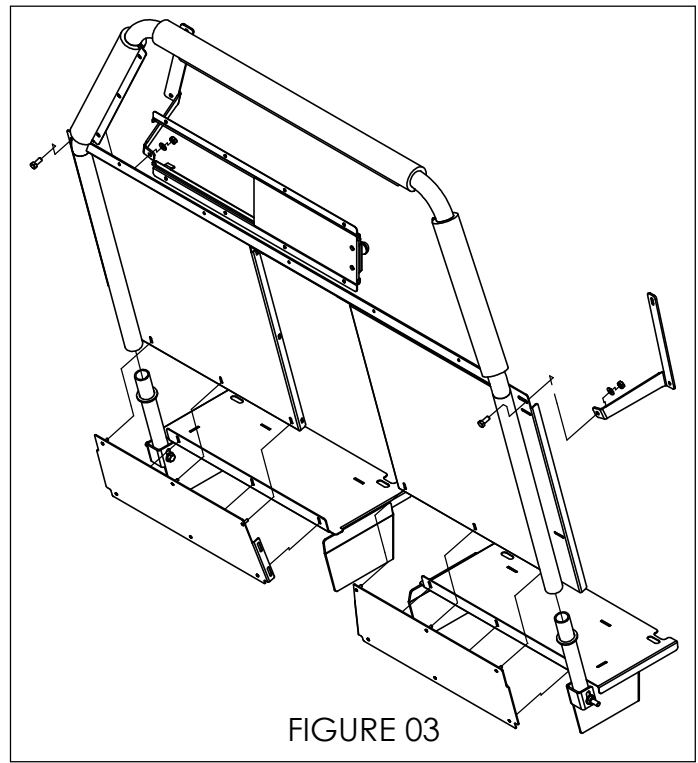

FIGURE 03

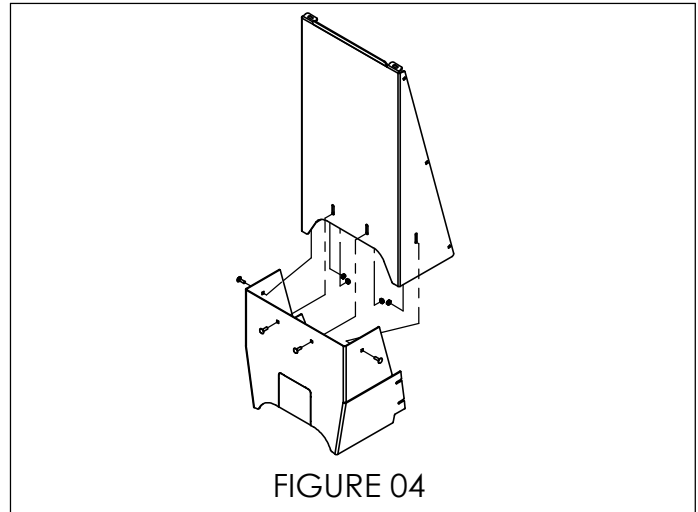

FIGURE 04

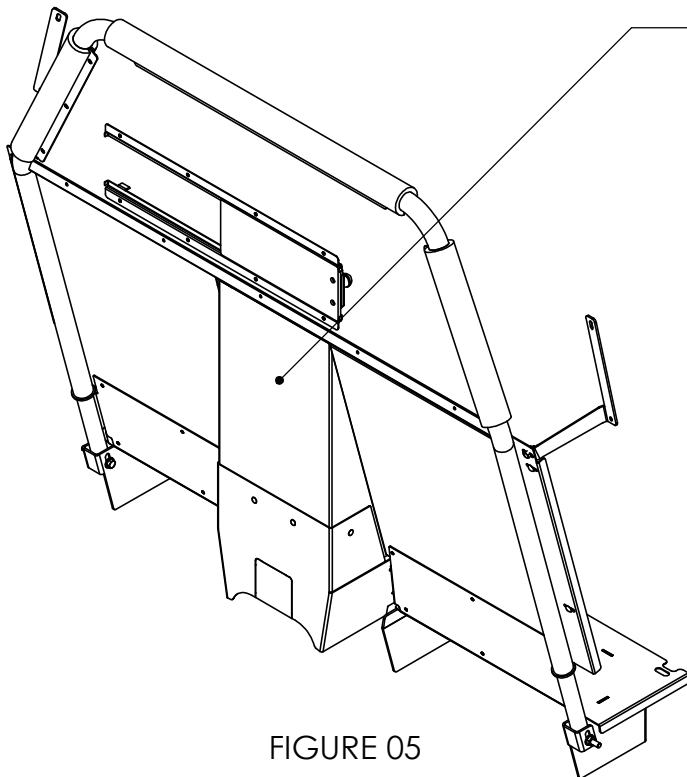

FIGURE 05

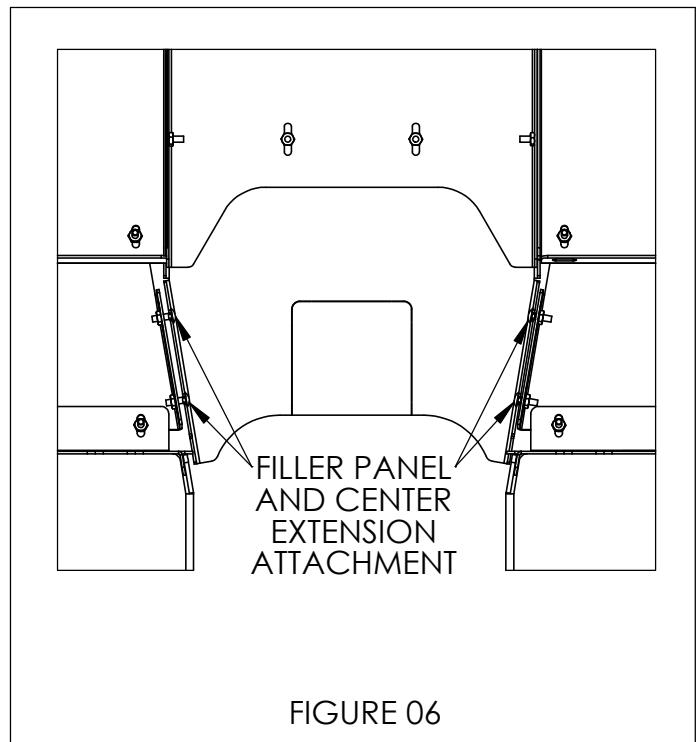

FIGURE 06

13. INSTALL LOWER WINGS USING #10-32 CARRIAGE BOLTS AND KEEPER NUTS. ENSURE THEY ARE ADJUSTED TO MINIMIZE GAPS ALONG THE B-PILLARS (FIGURE 07).
14. ATTACH THE UPPER WING BRACKETS TO THE UPPER WINGS USING #10-32 KEEPER NUTS (FIGURE 08).
15. REMOVE THE UPPER AND LOWER KEEPER NUTS ALONG THE RIGHT AND LEFT SIDE OF THE PARTITION WINDOW. ATTACH THE UPPER WING ASSEMBLIES TO THESE LOCATIONS USING THE REMOVED KEEPER NUTS (FIGURE 09).
16. ADJUST UPPER WING ASSEMBLIES TO MINIMIZE GAPS BETWEEN THE VEHICLES HEADLINER AND B-PILLARS.

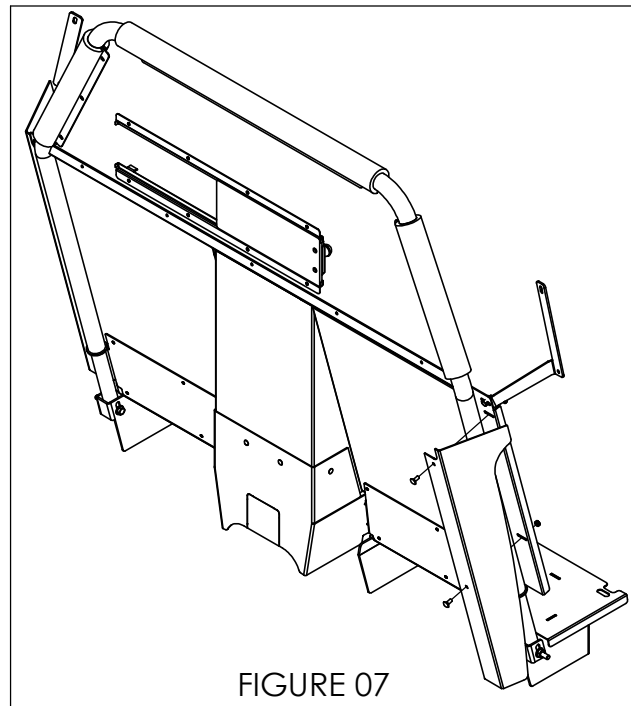

FIGURE 07

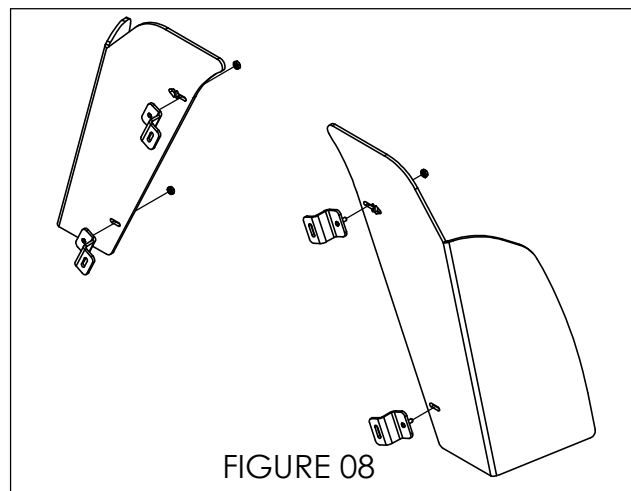

FIGURE 08

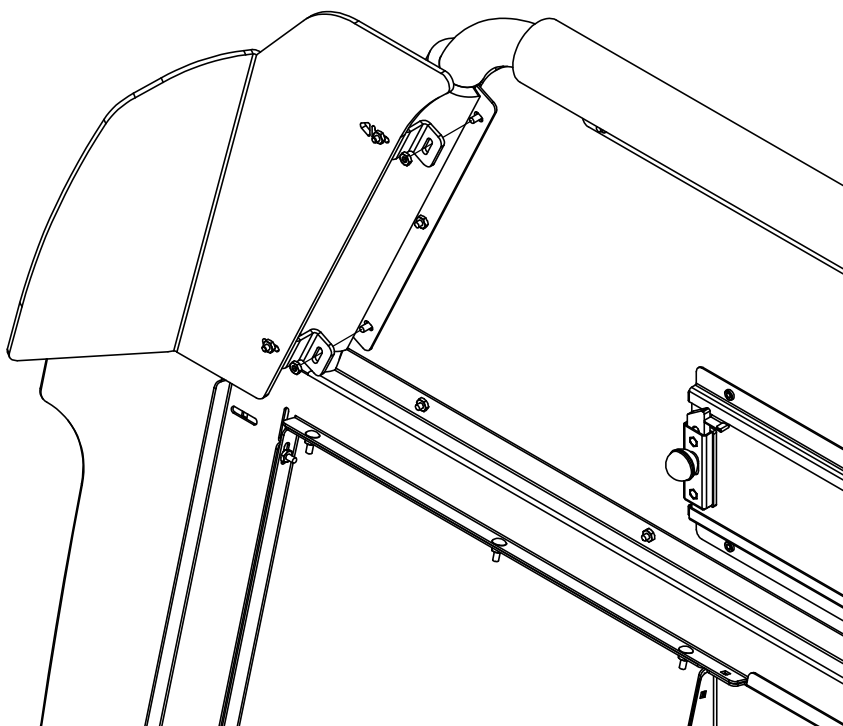

FIGURE 09

ITEM	QTY	DESCRIPTION
1	1	PARTITION, MAIN WELDMENT
13	2	PARTITION, LOWER TUBE WELDMENT
14	1	PARTITION, UTILITY INTERCEPTOR, PASSENGER SIDE UPPER WING
15	1	PARTITION, UTILITY INTERCEPTOR, DRIVER SIDE UPPER WING
16	1	PARTITION, UTILITY INTERCEPTOR, PASSENGER SIDE LOWER WING
17	1	PARTITION, UTILITY INTERCEPTOR, DRIVER SIDE LOWER WING
18	1	PARTITION, UTILITY INTERCEPTOR, PASSENGER SIDE B-PILLAR BRACKET
19	1	PARTITION, UTILITY INTERCEPTOR, DRIVER SIDE B-PILLAR BRACKET
20	1	PARTITION, CENTER EXTENSION
21	1	PARTITION, UTILITY INTERCEPTOR, DRIVER SIDE FOOT WELL
22	1	PARTITION, UTILITY INTERCEPTOR, PASSENGER SIDE FOOT WELL
23	4	PARTITION UPPER WING BRACKET
24	1	PARTITION, UTILITY INTERCEPTOR, RECESSED PANEL
25	1	PARTITION, UTILITY INTERCEPTOR, FLAT PANEL
26	1	PARTITION, UTILITY INTERCEPTOR, DRIVER SIDE FILLER PLATE
27	1	PARTITION, UTILITY INTERCEPTOR, PASSENGER SIDE FILLER PLATE
31	1	HARDWARE BAG, PARTITION, FORD UTILITY INTERCEPTOR
32	1	INSTRUCTION SHEET - FORD UTILITY INTERCEPTOR PARTITION

