



INSTALLATION INSTRUCTIONS

Product

7170-0646-01: STEEL STANDARD BAR
7170-0646-02: STEEL LIGHT BAR
7170-0646-03: ALUMINUM STANDARD BAR
7170-0646-04: ALUMINUM LIGHT BAR

Revision

E

Form

INST-824

PUSH BUMPER - FORD UTILITY 2016MY - 2019MY Printing Spec: PS-001

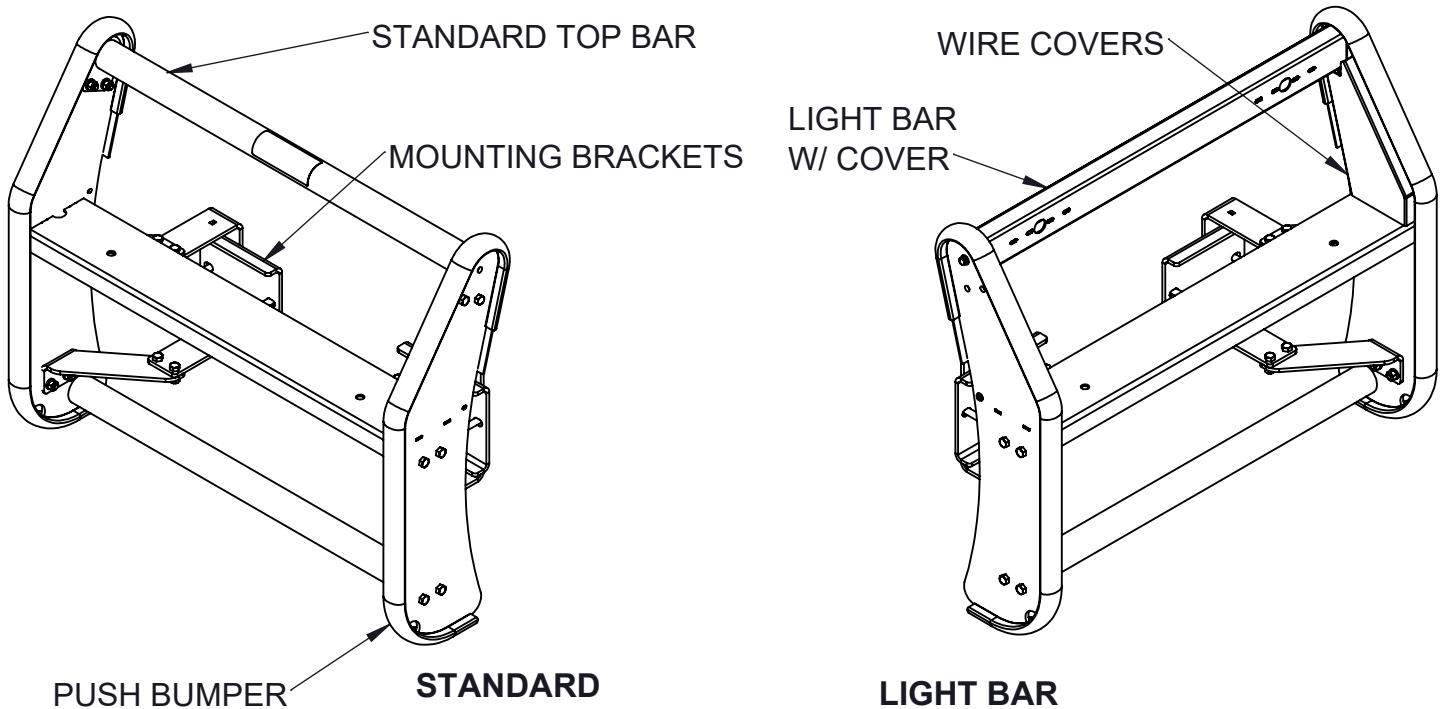

These instructions cover the installation of the Gamber-Johnson push bumper on 2016MY-2019MY and newer Ford Utility Police Interceptors. The push bumper can be purchased in the standard and light bar configurations. In the standard configuration the push bumper features a bolt in round top bar. In the light bar configuration the push bumper features a flat mounting bar for lights as well as two wire chase covers for routing wires down the sides of the push bumper. Both configurations feature the same push bumper as well as mounting brackets.

To Remove the Front Fascia:

1. Unbolt the radiator cover by removing the (7) 10mm bolts and (2) plastic clips.
2. Remove the (3) 8mm bolts from the bottom center of the front fascia. Remove the (3) 8mm bolts from each side that attach the bottom of the fascia to the inner fenders.
3. Remove the (7) 5.5 mm bolts along the front lip of each wheel well. Once removed pop the front of the wheel well trim out from the front fascia.
4. Bending the inner fender back slightly, reach in and remove the (3) 10mm bolts that attach the front fender to the front fascia on each side. See FIG 1 below for their location.
5. Remove the front fascia and disconnect any wires attached to it. Set the front fascia aside.

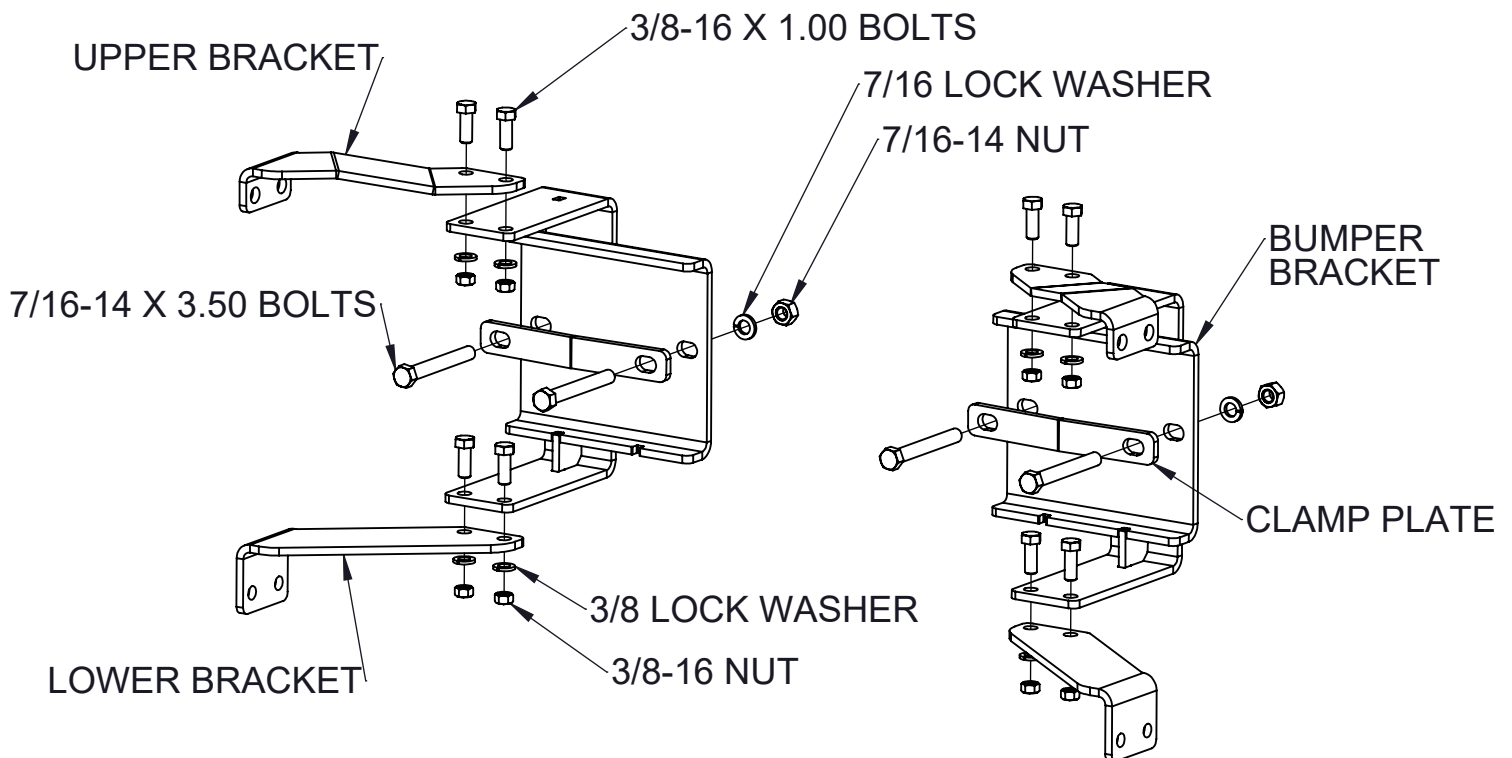

FIG 1 - (3) Fender Bolt Locations

To Install Mounting Brackets:

1. Attach the driver side bumper bracket and clamp plate to the driver side of the bumper beam using the 7/16-14 x 3.50 bolts, lock washers and nuts provided. The bolts must be placed through the bracket, through the holes in the factory bumper and through the clamp plate. Repeat for the passenger side bracket. Do not tighten the bolts yet.
2. Test fit the rest of the brackets and push bumper before tightening. Do this by attaching the upper and lower brackets for the both the driver and passenger side using the 3/8-16 x 1.00 bolts, lock washers and nuts provided. See the diagram below for reference. Note that the upper bracket is installed above the bumper bracket while the lower bracket is installed below. Finally, attach the push bumper to these brackets, again using the 3/8-16 hardware provided. Once the push bumper has been test fit, tighten the bumper brackets installed in step 1 then remove the push bumper and brackets installed in this step.

NOTE: The bolt nearest the driver's side may come into contact with one of the lines for the oil cooler. It is recommended that electrical tape or wire loom be placed around the oil cooler line to prevent the tip of the bolt from wearing the hose.



Push Bumper Bracket Installation

3. Hold the fascia/bumper cover up to the vehicle making sure it is properly aligned. Note the positions of the lower flanges of the bumper brackets on the lower grille section and mark their position to cut slots.
4. Cut two slots in the lower grille opening for the flanges to pass through. See FIG 2 below for reference of the location of the slots.
5. Reinstall the front fascia and radiator cover.
6. Attach the upper/lower brackets and push bumper the same as the test fit from Step 2. Tighten all of the bolts connecting the brackets and push bumper.

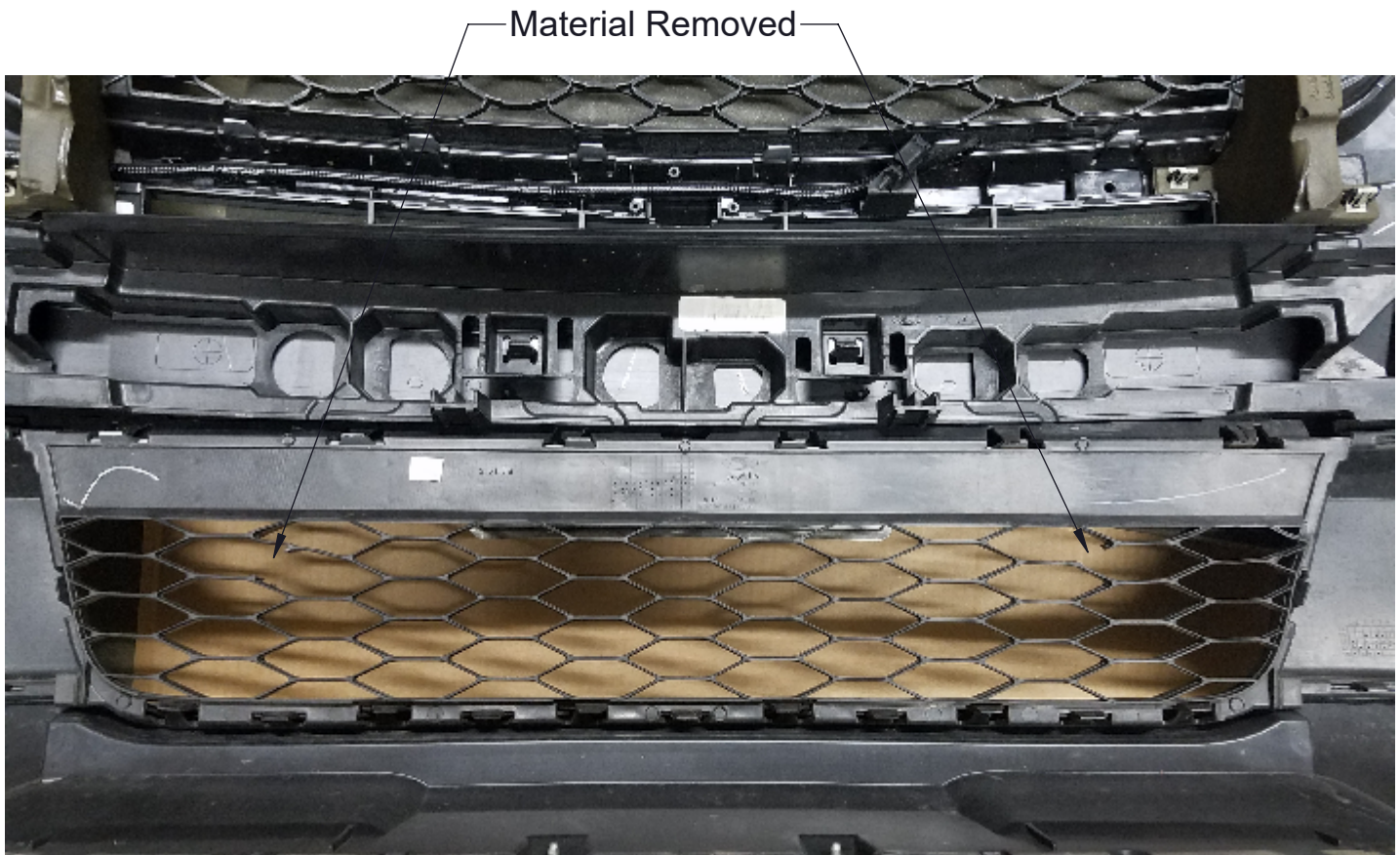

Driver Side

FIG 2 - Lower Grille Trimming Reference

Passenger Side

To Install Round Top Bar:

1. Bolt the round upper bar in place using the 3/8-16 x 1.00 bolts, lock washers and nuts provided.

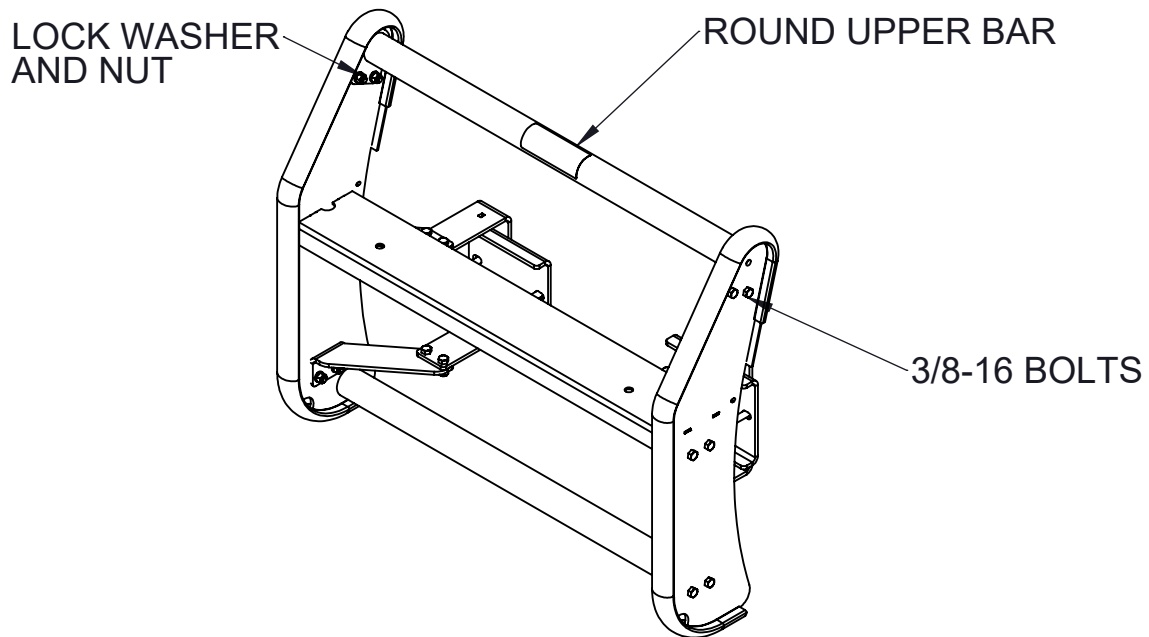

To Install Light Bar:

1. After the lights have been installed in the light bar, align the light bar and rear cover with the top holes in the push bumper. Wires can be guided through the notches at either end of the light bar. Install the light bar and cover using the 1/4-20 x 1.00 bolts and washers provided.
2. The side wire chase covers can be installed to guide wires down from the light bar to the flat plate in the middle of the push bumper. The covers are installed using #10-32 x 0.500 machine screws and #10 washers. The edges of the cover may need to be tucked underneath the flexible rubber strip on the front of the push bumper to be installed.

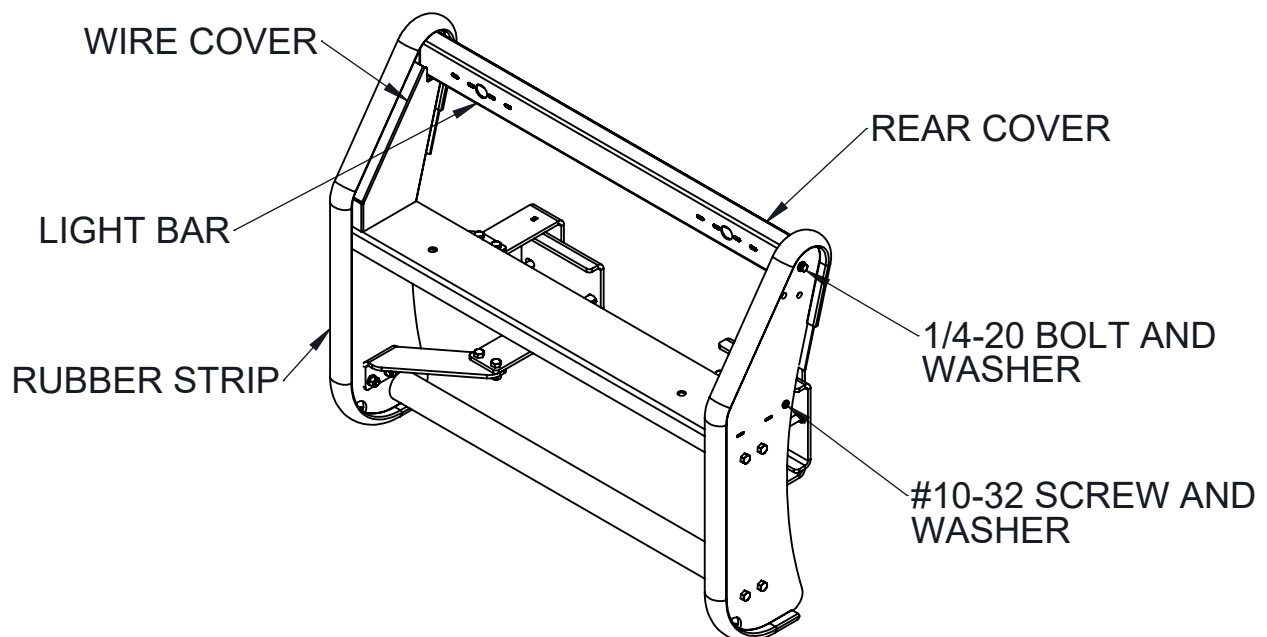

To Install Lights on Bar:

- 1. Knock out the two knockouts that line up with the mounting holes of chosen light. Bolt light onto bar per light instructions.

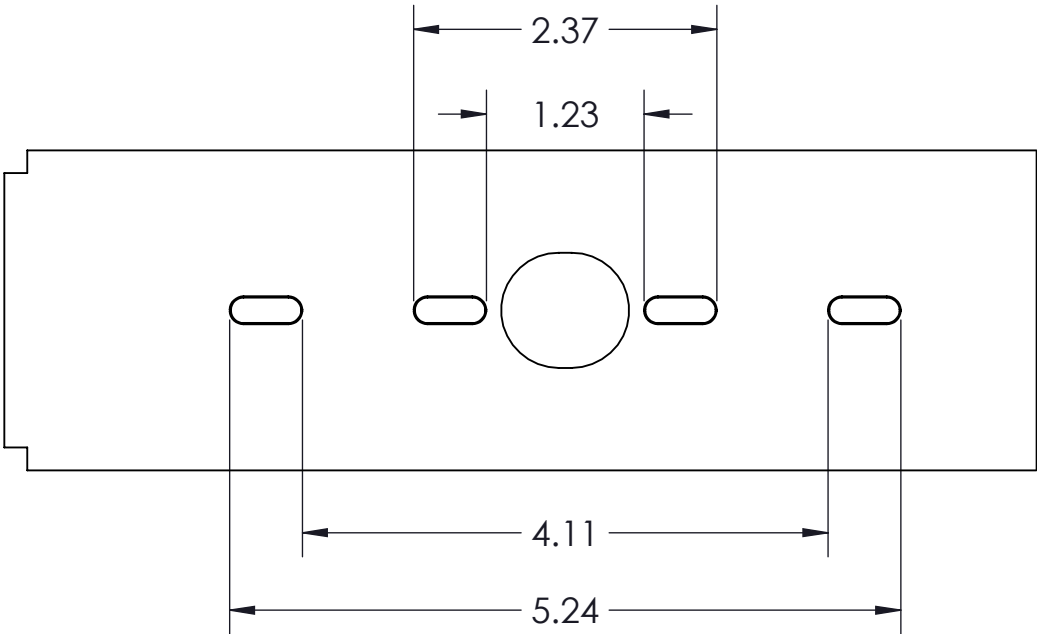

Acceptable Lights:

- 1. The light bar knockouts are designed for the following light models:

Code3:	M180 (surface mount)
	MR6 (surface mount)
Federal Signal:	MicroPulse
	MicroPulse Ultra
	MicroPulse Wide Angle
Feneix:	Fusion (surface mount)
Sound Off Signal:	mPower 3" Stud
	mPower 4" Stud
	nForce (surface mount)
Whelen:	ION (surface mount)
	T-ION