



# INSTALLATION INSTRUCTIONS

## Product

7160-1294

**CF-20 TABLET BRACKETS**

## Revision

Rev.A

## Form

INST-864

Printing Spec: PS-001

This instruction sheet shows the process for attaching the 7160-1294 CF-20 Tablet Brackets to the CF-20 dock for vertical installation tablet use.

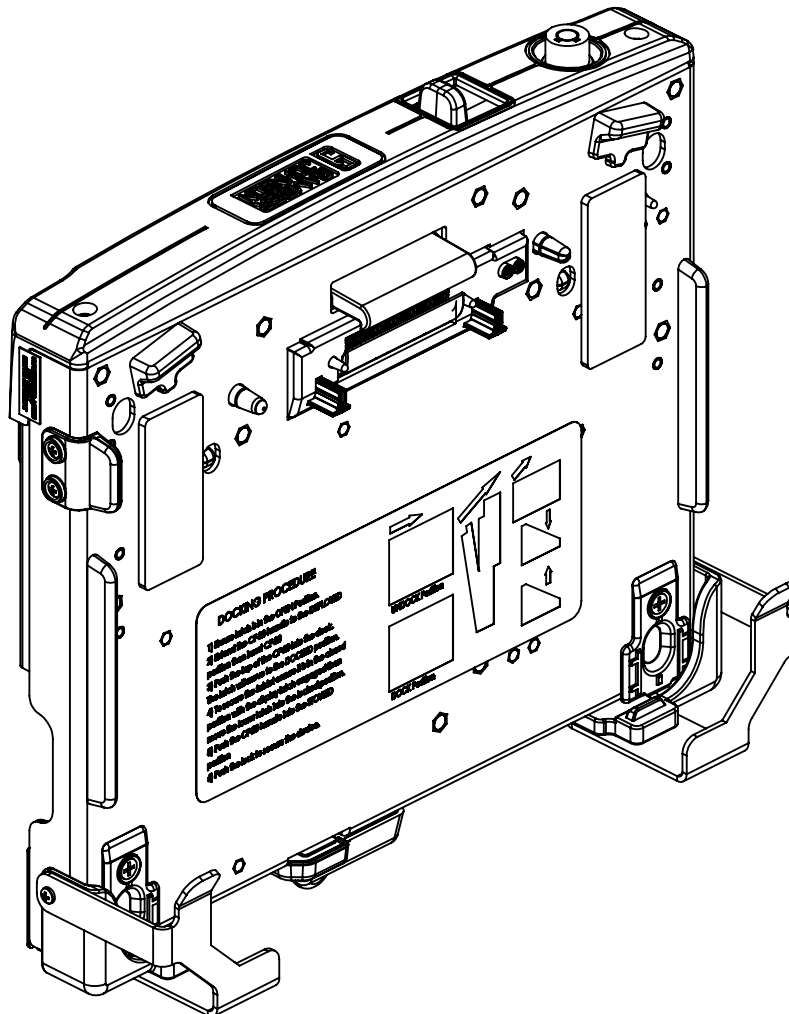

### Product Mounting Disclaimer

Gamber-Johnson is not liable under any theory of contract or tort law for any loss, damage, personal injury, special, incidental or consequential damages for personal injury or other damage of any nature arising directly or indirectly as a result of the improper installation or use of its products in vehicle or any other application. In order to safely install and use Gamber-Johnson products full consideration of vehicle occupants, vehicle systems (i.e., the location of fuel lines, brakes lines, electrical, drive train or other systems), air-bags and other safety equipment is required. Gamber-Johnson specifically disclaims any responsibility for the improper use or installation of its products not consistent with the original vehicle manufactures specifications and recommendations, Gamber-Johnson product instruction sheets, or workmanship standards as endorsed through the Gamber-Johnson Certified Installer Program.

© Copyright 2017 Gamber-Johnson, LLC

If you need assistance or have questions, call Gamber-Johnson at 1-800-456-6868

## **Attaching the brackets to 7160-1265:**

### **Left Side Bracket:**

1 - Remove and discard both of the screws on the left corner bracket of the dock

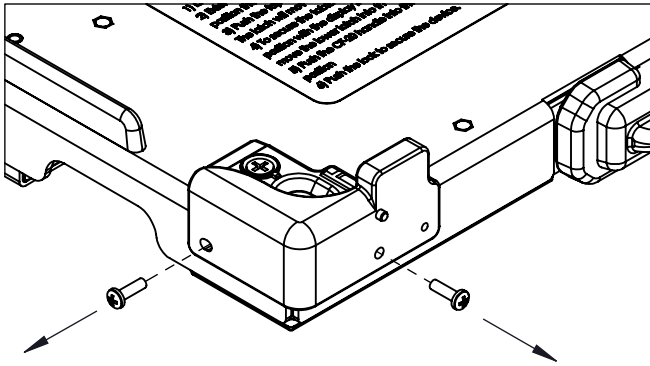

2 - Align the left tablet bracket and attach it to the dock with two of the screws included in the kit

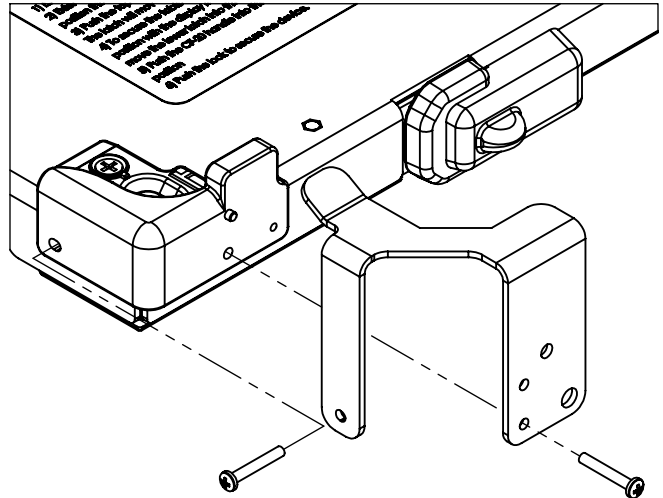

### **Right Side Bracket:**

Repeat the same process on the right side of the dock

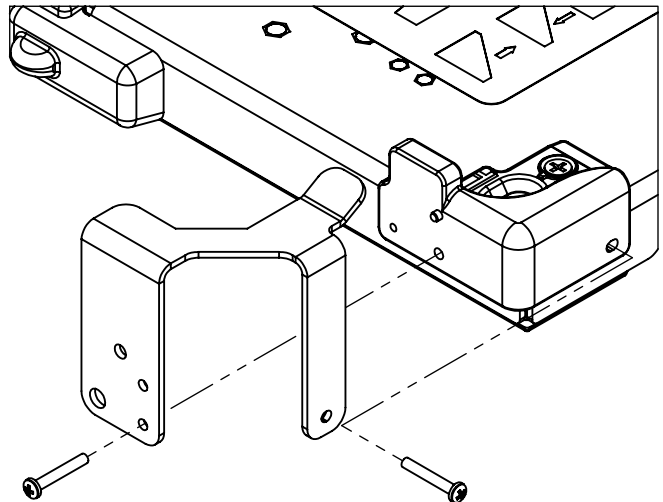
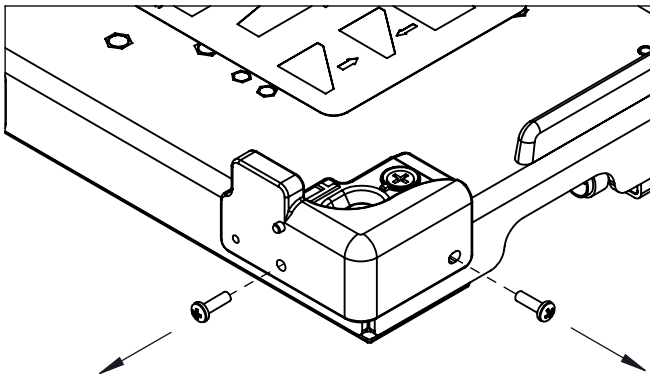

## **Attaching the brackets to 7160-0802:**

The CF-20 tablet brackets are backwards compatible with the previous version of the dock

### **Left Side Bracket:**

1 - Remove ONLY the two screws indicated below in the left corner bracket of the dock

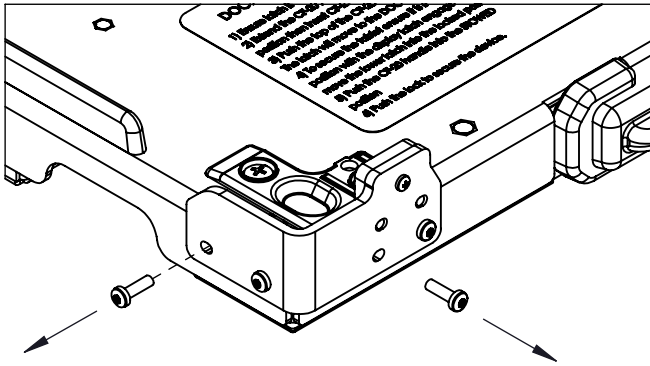

2 - Align the left tablet bracket and replace the two screws removed in step 1

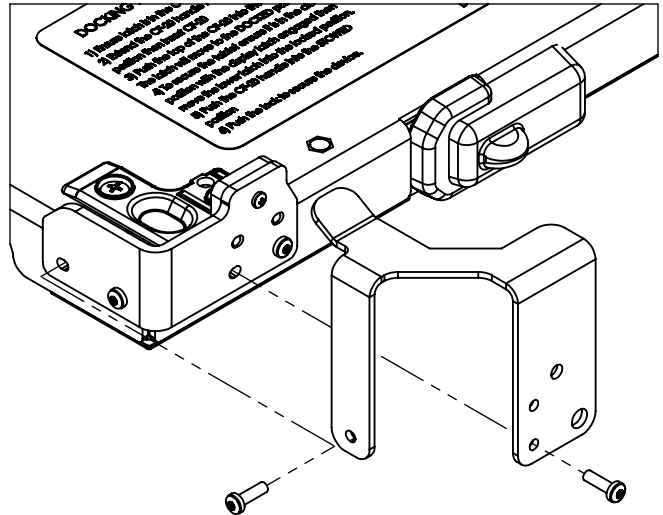

### **Right Side Bracket:**

Repeat the same process on the right side of the dock

