



INSTALLATION INSTRUCTIONS

Product

7170-0649-01: STEEL STANDARD BAR
7170-0649-02: STEEL LIGHT BAR
7170-0649-03: ALUMINUM STANDARD BAR
7170-0649-04: ALUMINUM LIGHT BAR
PUSH BUMPER - DODGE CHARGER

Revision

REV. C

Form

INST-831

Printing Spec: PS-001

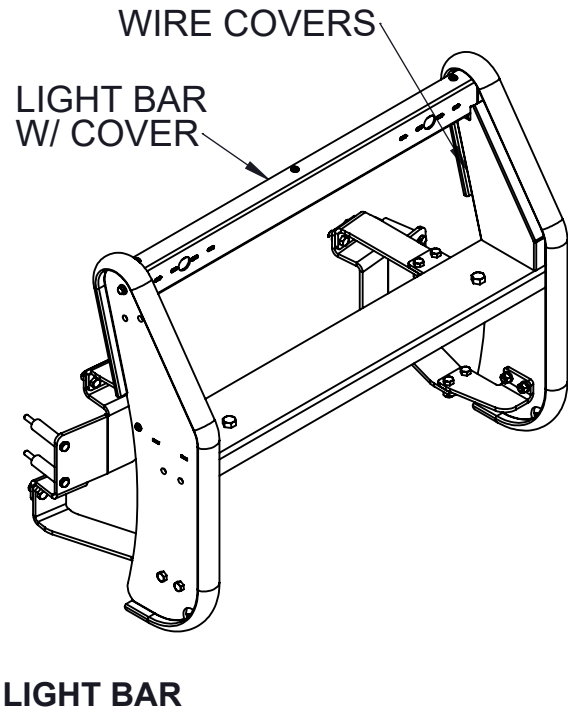
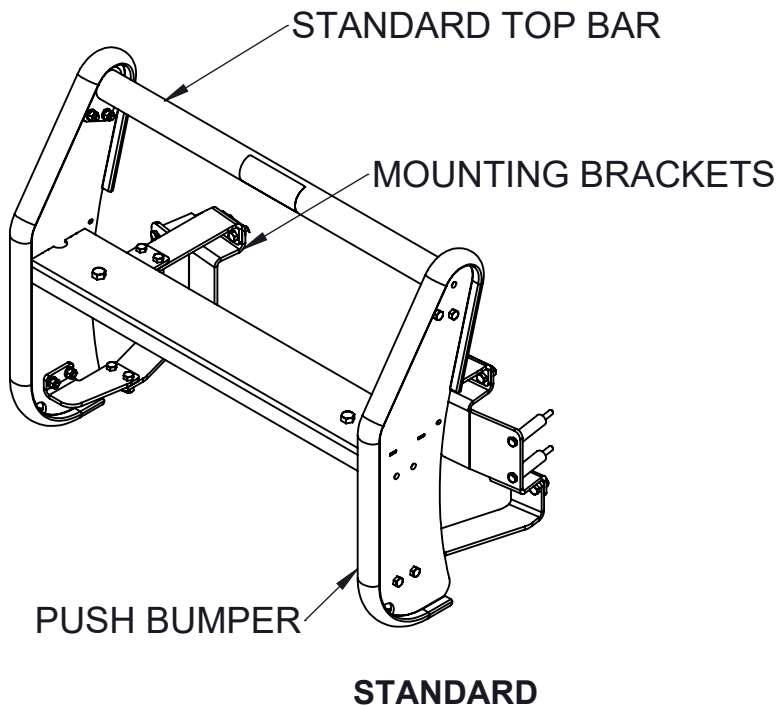

These instructions cover the installation of the Gamber-Johnson push bumper on 2011 and newer Dodge Chargers. The push bumper can be purchased in the standard and light bar configurations. In the standard configuration the push bumper features a bolt in round top bar. In the light bar configuration the push bumper features a flat mounting bar for lights as well as two wire chase covers for routing wires down the sides of the push bumper. Both configurations feature the same push bumper as well as mounting brackets.

Installing Mounting Brackets:

1. Unbolt the front fascia/bumper cover. Pull the fascia away from the car and unplug the electrical connections to the fog lights. Remove and set the fascia aside.
2. There are eight 8mm bolts holding the bumper beam to the car; remove the four bolts closest to the center of the vehicle. Save the bolts in case the car ever needs to be returned to its stock configuration.
3. Insert the two M8-1.25 x 100mm bolts into the slots on the left bumper bracket and slide a spacer tube onto each bolt. Place the left bumper bracket on the driver side of the bumper beam inserting the new bolts and spacer tubes into the slots from which the factory bolts were removed in Step 2. Tighten the bolts and repeat for the right bumper bracket.
4. Attach the upper and lower brackets to the bumper brackets with the 3/8-16 x 1.00 bolts, lock washers and hex nuts provided.
5. Hold the fascia/bumper cover up to the car making sure it is properly aligned with the headlights. Note the positions of the upper and lower brackets and mark locations for slots to allow the brackets to pass through.
6. Cut four slots in the fascia for the brackets to pass through.
7. Reconnect the fog lights and reinstall the fascia/bumper cover.
8. Attach the upper and lower extension brackets with the 3/8-16 x 1.00 bolts, lock washers and hex nuts provided. The extensions should be placed on top of the upper brackets.
9. Attach the push bumper to the lower extensions with the 3/8-16 x 1.00 bolts, lock washers and hex nuts provided. Attach the upper extensions using the 1/2-13 x 1.25 bolts, lock washers and hex nuts provided.
10. It is recommended that the exterior bolt heads and nuts are painted or another method is used to prevent corrosion.

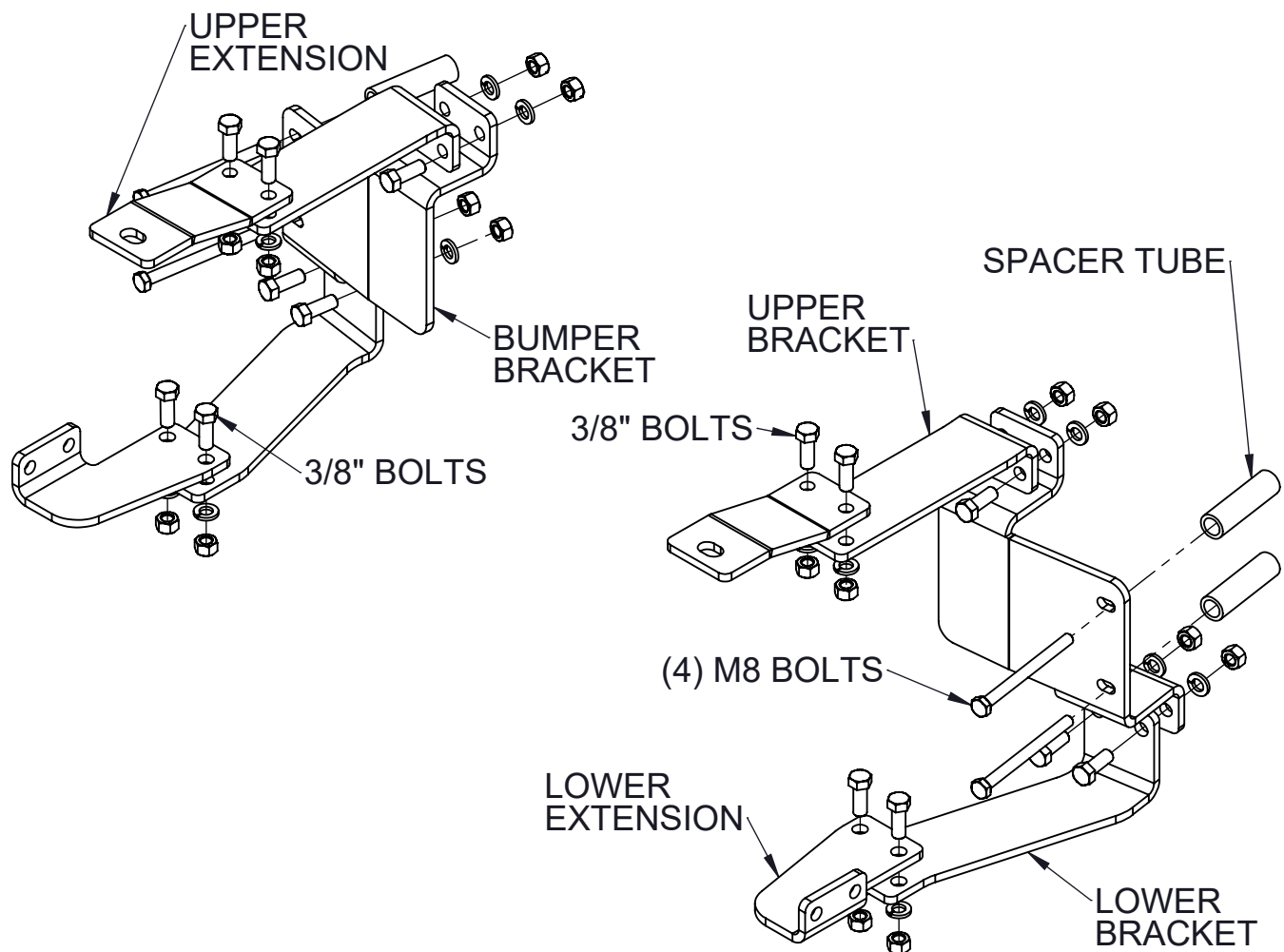

To Install Round Top Bar:

1. Bolt the round upper bar in place using the 3/8-16 x 1.00 bolts, lock washers and nuts provided.

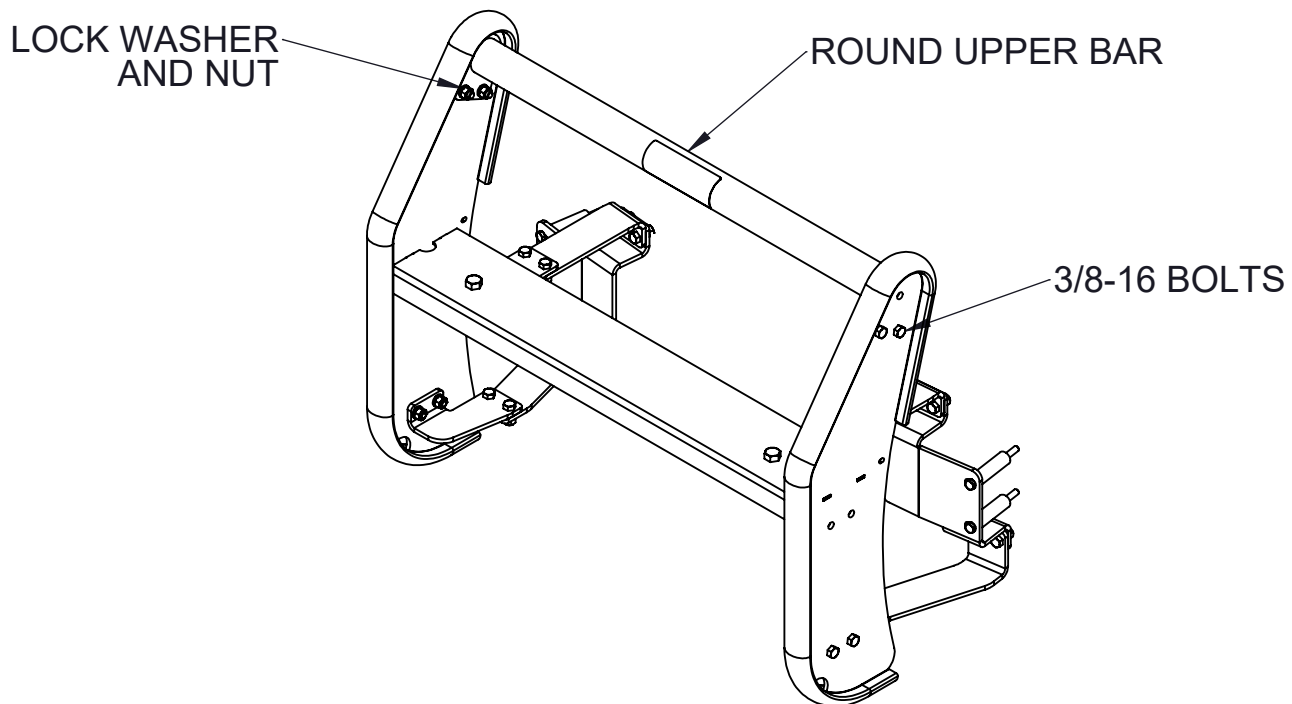

To Install Light Bar:

1. After the lights have been installed in the light bar attach the rear cover using the (3) #10-32 machine screws and washers that came installed with the light bar.
2. Align the light bar cover with the top holes in the push bumper. Wires can be guided through notches at either end of the light bar. Install the light bar using the 1/4-20 x 1.00 bolts and washers provided.
3. The side wire chase covers can be installed to guide wires down from the light bar to the flat plate in the middle of the push bumper. The covers are installed using #10-32 x 0.500 machine screws and washers. The edges of the covers may need to be tucked underneath the flexible rubber strip on the front of the push bumper to be installed.

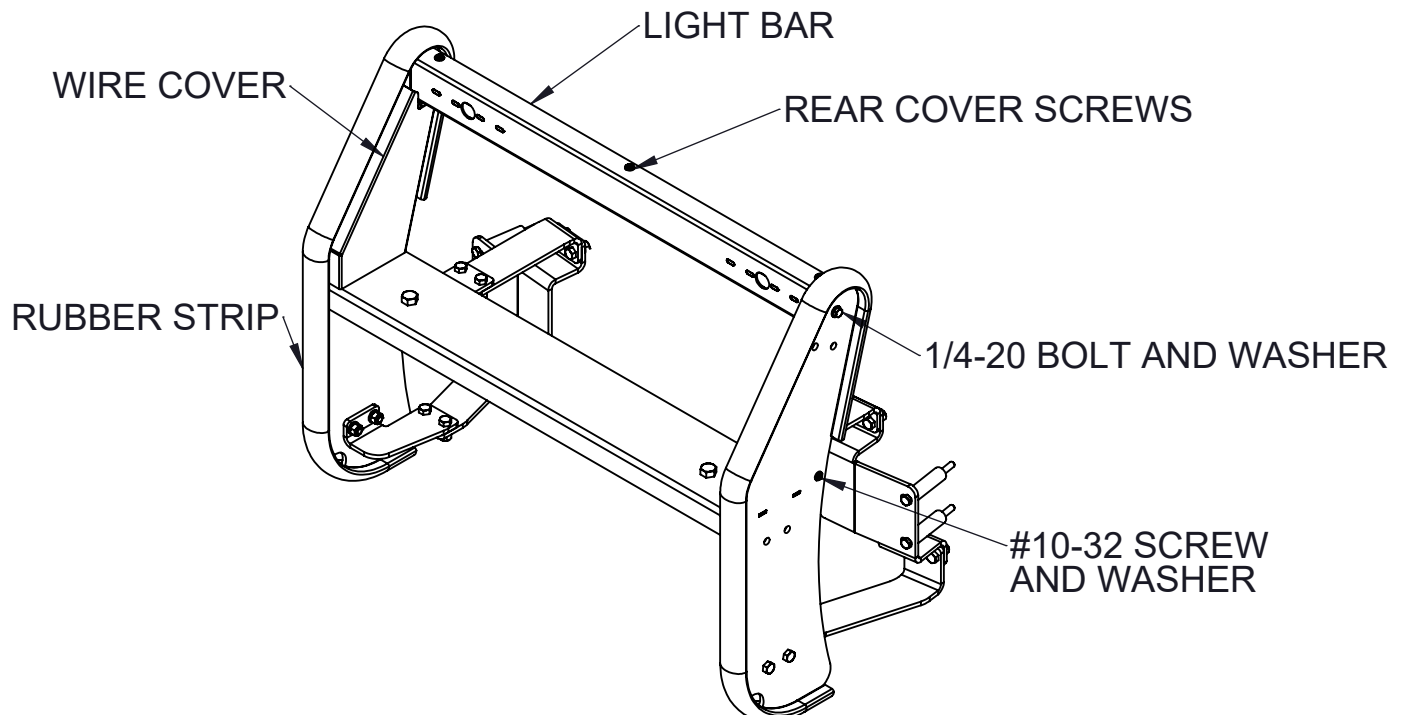

To Install Lights on Bar:

1. Knock out the two knockouts that line up with the mounting holes of chosen light. Bolt light onto bar per light instructions.

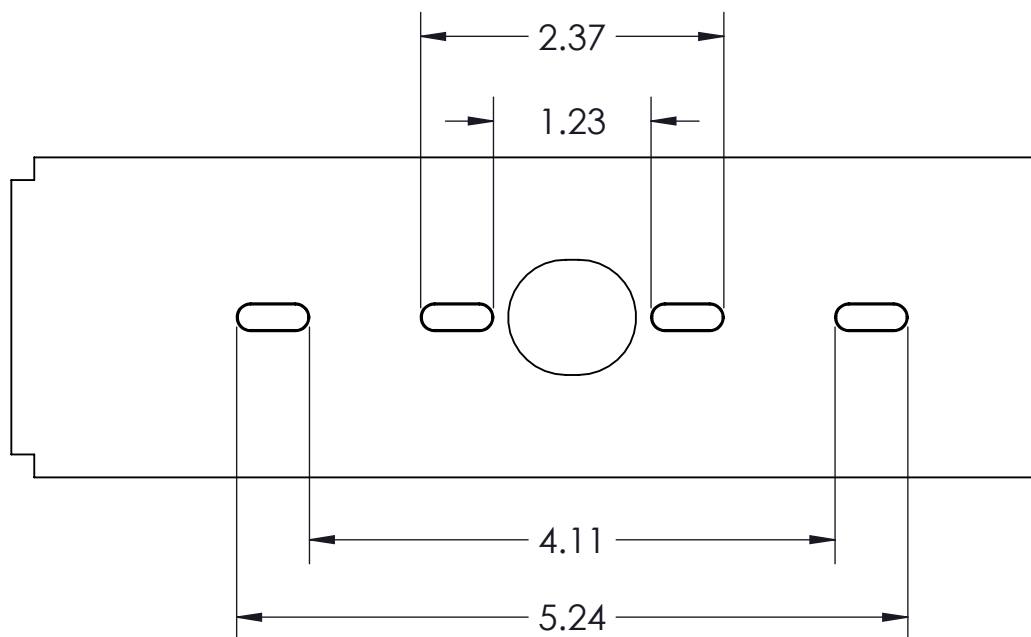

Acceptable Lights:

1. The light bar knockouts are designed for the following light models:

Code3:	M180 (surface mount)
	MR6 (surface mount)
Federal Signal:	MicroPulse
	MicroPulse Ultra
	MicroPulse Wide Angle
Feneix:	Fusion (surface mount)
Sound Off Signal:	mPower 3" Stud
	mPower 4" Stud
	nForce (surface mount)
Whelen:	ION (surface mount)
	T-ION