



Very Well Connected™

# INSTALLATION INSTRUCTIONS

## Product

**7160-0917**

**Side Panels - Ford Expedition 2007-2017**

## Revision

**A**

## Form

**INST-765**

**Printing Spec:PS-001**

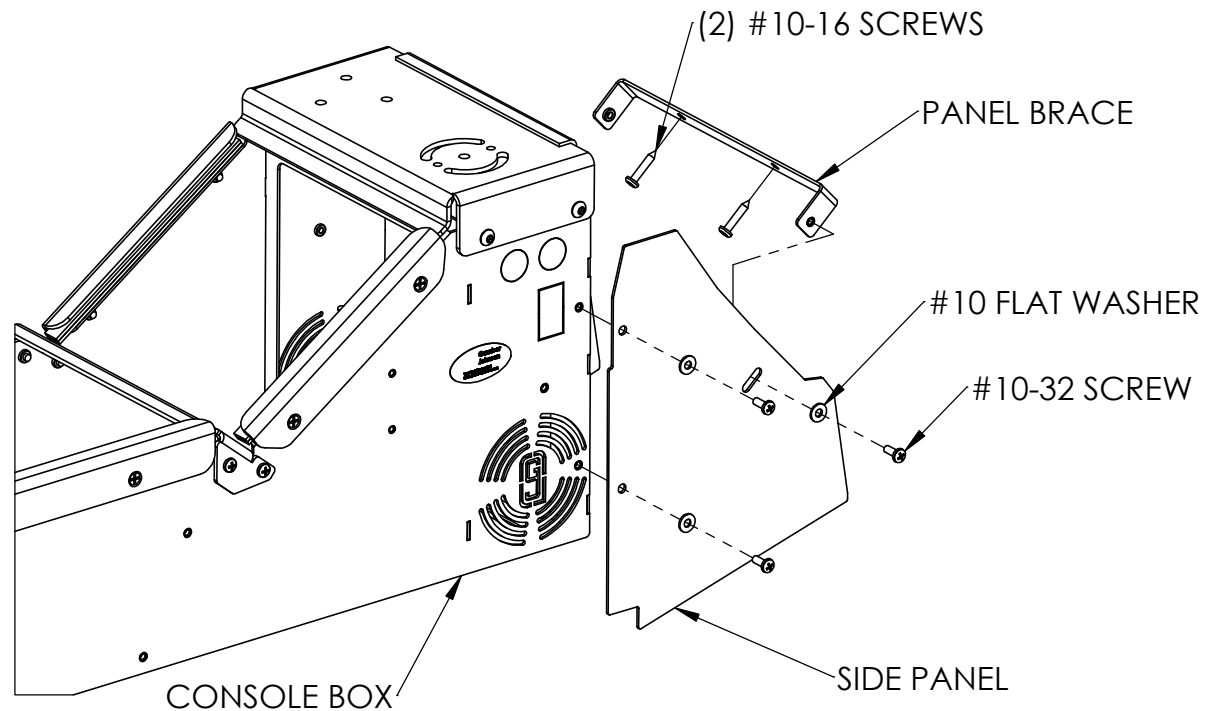

The side panels for the Ford Expedition (2007-2017) can be attached to the front of the console box to fill the gap between the console box and the vehicle's dash.

To install the side panels:

1. Attach the side panels to the box using the #10-32 screws and #10 flat washers provided in the hardware bag.
2. Install the side panel brace between the panels with the #10-32 screws and #10 flat washers. Using the slotted holes, push the brace up against the vehicle plastic before tightening the screws.
3. **Optional:** Using the #10-16 sheet metal screws provided in the hardware bag, attach the brace to the vehicle plastic. Verify there are no obstructions behind the plastic prior to installing the screws.

#### Product Mounting Disclaimer

Gamber-Johnson is not liable under any theory of contract or tort law for any loss, damage, personal injury, special, incidental or consequential damages for personal injury or other damage of any nature arising directly or indirectly as a result of the improper installation or use of its products in vehicle or any other application. In order to safely install and use Gamber-Johnson products full consideration of vehicle occupants, vehicle systems (i.e., the location of fuel lines, brakes lines, electrical, drive train or other systems), air-bags and other safety equipment is required. Gamber-Johnson specifically disclaims any responsibility for the improper use or installation of its products not consistent with the original vehicle manufactures specifications and recommendations, Gamber-Johnson product instruction sheets, or workmanship standards as endorsed through the Gamber-Johnson Certified Installer Program.

© copyright 2016 Gamber-Johnson, LLC

If you need assistance or have questions, call Gamber-Johnson at 1-800-456-6868