

# INSTALLATION INSTRUCTIONS

## Product

7160-0121 VEHICLE LEG KIT

CHEVROLET IMPALA (2006+)

## Revision

Rev. E

## Form #

INST-385

Printing Spec: PS-001

**Note: Check fit between the Impala base and prisoner screen. Modifications to prisoner screen panels may be required in some applications. It is highly recommended that Leg Kit be installed prior to installing the prisoner screen, if used.**

## 2006 - 2011 Models Install Instructions

1. Detach the Cup Holder from the Anti-Crush Plate by removing the four screws located on the top of the Cup Holder tray. (Figure 1)

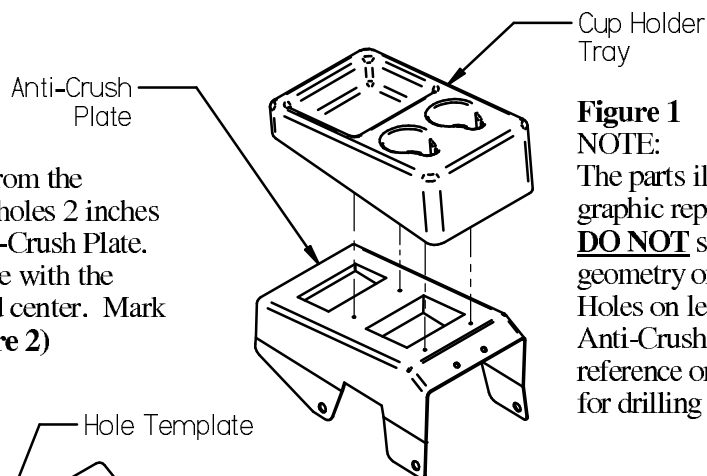
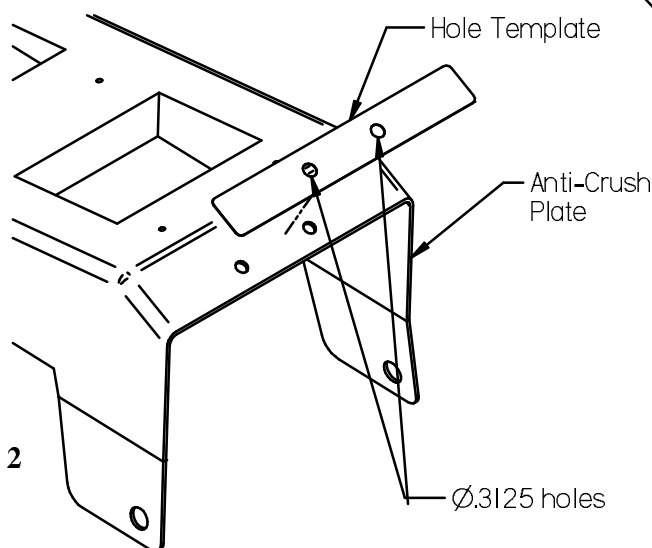

**Figure 1**

### NOTE:

The parts illustrated here are graphic representations and **DO NOT** show the exact geometry of the actual parts. Holes on leading edge of Anti-Crush Plate are shown for reference only. Refer to Step 2 for drilling instructions

2. Using the red fabric Hole Template from the hardware bag locate and drill two 5/16" holes 2 inches apart in the front, angled tab on the Anti-Crush Plate. Align the long edge of the Hole Template with the leading edge of the Anti-Crush Plate and center. Mark holes, remove template, and drill. (Figure 2)



**Figure 2**

3. Line up the Impala Rear Leg 1 (p/n 12815) to the under side of the Anti-Crush Plate with the threaded studs facing the front of the vehicle. Using two 1/4-20 x .75" Hex-Head Screws and two 1/4" Flat Washers, attach the leg by inserting the screws through the washers and the Anti-Crush Plate into the nuts attached to Leg 1. (Figure 3)

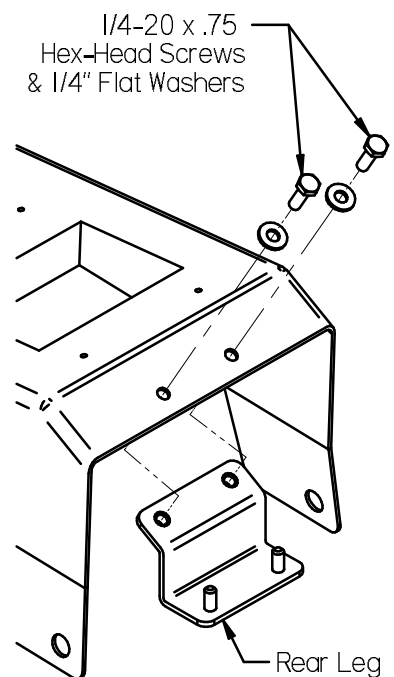

**Figure 3**

### Product Mounting Disclaimer

Gamber-Johnson is not liable under any theory of contract or tort law for any loss, damage, personal injury, special, incidental or consequential damages for personal injury or other damage of any nature arising directly or indirectly as a result of the improper installation or use of its products in vehicle or any other application. In order to safely install and use Gamber-Johnson products full consideration of vehicle occupants, vehicle systems (i.e., the location of fuel lines, brakes lines, electrical, drive train or other systems), air-bags and other safety equipment is required. Gamber-Johnson specifically disclaims any responsibility for the improper use or installation of its products not consistent with the original vehicle manufacturer's specifications and recommendations, Gamber-Johnson product instruction sheets, or workmanship standards as endorsed through the Gamber-Johnson Certified Installer Program.

© copyright 2012 Gamber-Johnson, LLC

If you need assistance or have questions, call Gamber-Johnson at 1-800-456-6868

## 2006 - 2011 Chevrolet Impala Leg Kit

4. Attach Rear Leg 2 to Rear Leg 1 by placing the two non-threaded holes on Leg 2 onto the threaded studs on Leg 1. Fasten one 1/4" Flat Washer and one 1/4-20 Nylok Nut to each stud to secure Leg 2. (Figure 4)

5. Take notice of the way in which the front seats attach to the vehicle. The front edge of each seat leg has two hooks that go into the floor (Figure 5).

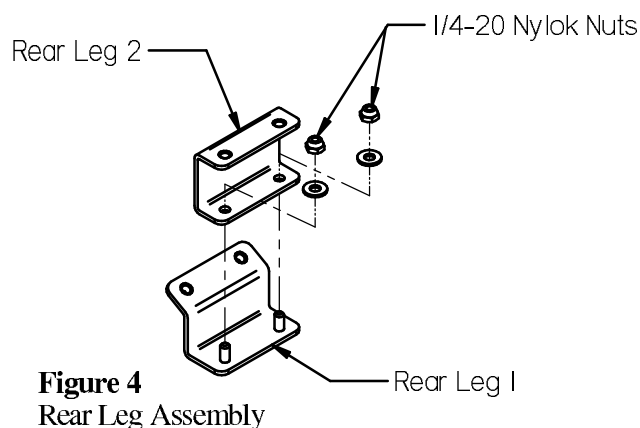
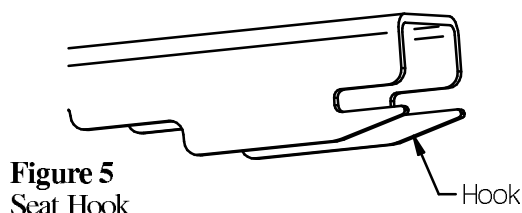

6. To install the anchor feet, the front passenger's and driver's seats must be removed from the vehicle floor. Slide the seats all the way forward to access and remove the two seat bolts found at the rear of the seat frame.

7. After removing the seat bolts, slide the seat all the way back. Tilt the back rest all the way back. Remove the seat by lifting the back of the seat first and sliding it towards the back of the vehicle. Tilt the entire seat, back and away from the mounting area. Remove the two plastic covers. They will interfere if left in place. **NOTE:** The "hooks" on the front of the seat rails (Figure 5). The space in between the hooks will be important later in STEP 10.

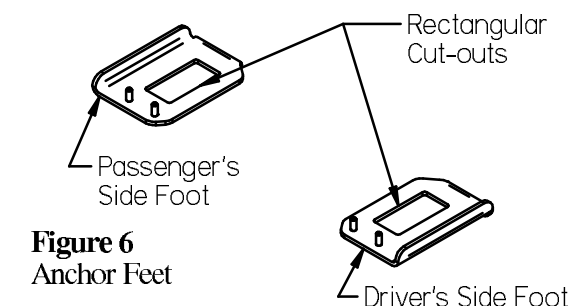

8. Place the two anchor feet over the in-board cut-outs for the seat hooks with the vertical flanges oriented away from the middle of the vehicle. Tilt the seats forward and insert the "hooks" through the rectangular cut-outs in the anchor feet and into the mounting slots on the floor of the vehicle. (Figure 6).

9. Verify that the seat frame is contacting the vehicle floor in the same manner as prior to removing the seats. The feet should not be pinched under the seat frame. With the seat "hooks" properly engaged the feet should be able to move slightly. If they are pinched, they will not move at all and it will be necessary to re-align the seat. Once the feet are aligned properly, replace the seat bolts at the rear of the seat frame.

10. With each of the two anchor legs included, insert the small tab into the space between the "hooks." (see note from Step 7) It will be necessary to insert the anchor legs at an angle, for there will be very little clearance between the seat frame and the threaded studs of the anchor feet. Use the included 1/4-20 Nylok nut (4X) and the 1/4 inch inner diameter flat washers (4X) to fasten the legs as shown in Figure 7, but do not tighten at this time.

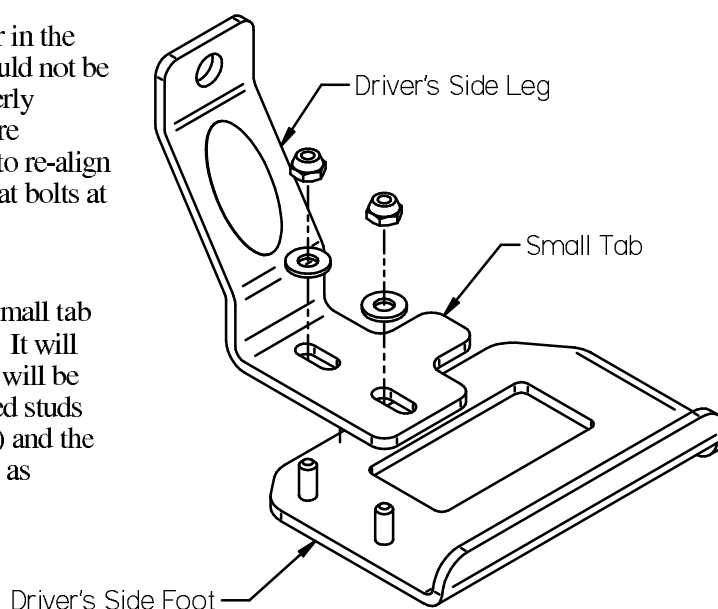

**11.** Align the top plate on the two anchor legs and the rear leg. Fasten the top plate with necessary hardware. Tighten the hardware on the anchor feet. Replace the Cupholder by inserting the front edge into the space provided between Rear Leg 1 and Rear Leg 2 (**Figure 8**). This completes the installation of the Chevy Impala Leg Kit. Add a console box, cup holders, arm rest, and other desired equipment to complete the solution.

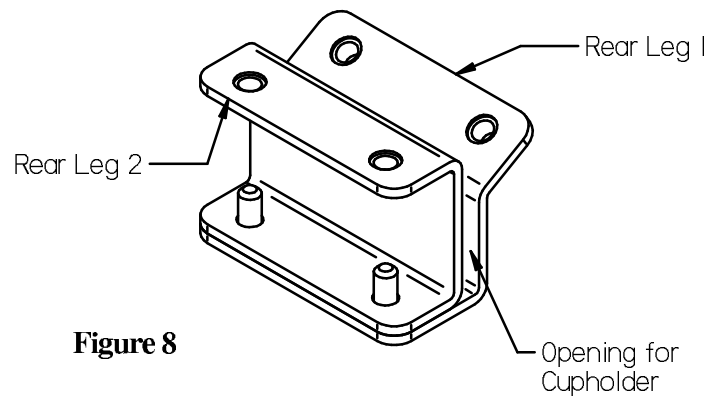

**Figure 8**

## **2012 and newer Models Install Instructions**

**12.** 2012 and newer vehicles include a sensor device under the floor covering on the transmission hump, which requires a different mounting method. Remove the factory cupholder and add mounting holes to the Anti-Crush plate as described above in Steps 1-2.

Rear Leg 1



**Figure 9**

**13.** Attach the Impala Rear Leg 1 (p/n 12815) to the underside of the Anti-Crush Plate, inserting the threaded studs thru the drilled mounting holes and securing with two .25-20 Flat Washers and Nylok Nuts (**Figure 9 & 10**)

.25-20 Washers & Nylok Nuts

Rear Leg 1

Anti-Crush Plate

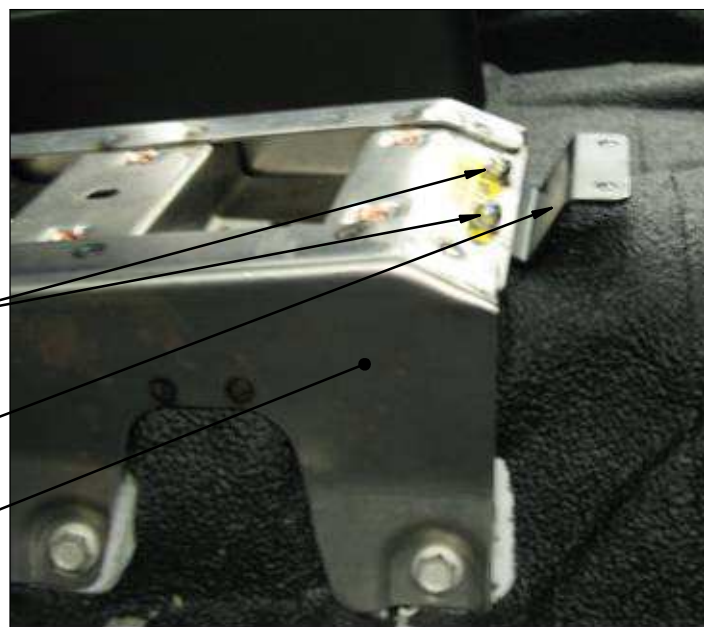

**Figure 10**

14. Notch the plastic edge of the factory cupholder as needed to clear the leg and reinstall the factory cupholder (Figure 11).

Align the top plate on the two anchor legs and the rear leg. Fasten the top plate with necessary hardware. Tighten the hardware on the anchor legs.

Add a console box, cup holders, armrest and other desired equipment to complete the solution.

Figure 11

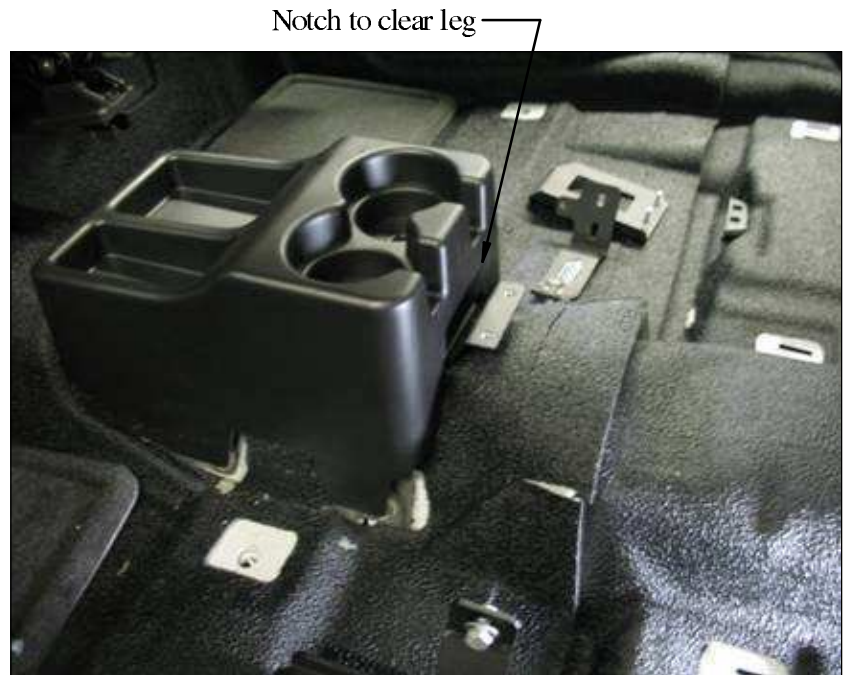

## All Models - Interfacing the Impala Leg Kit with the Impala Vehicle Base

The Chevy Impala leg kit (p/n 7160-0121) can be used in conjunction with the Chevy Impala Vehicle base (7160-0055).

1. Substitute the vehicle base (7160-0055) for the passenger's side anchor foot.
2. You can refer to INST-326 for the installation of the vehicle base, but the method is similar to the previous instructions within this document. See **Figure 12** for an illustration of the a completed install with a vehicle base.

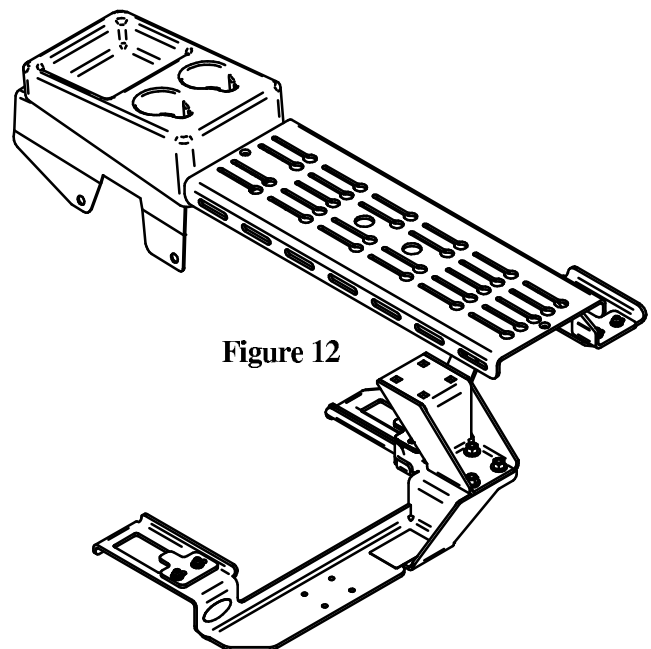

Figure 12