



Very Well Connected™

INSTALLATION INSTRUCTIONS

Product

7160-0062; 7160-0590; 7160-0596

**Toyota Tundra Vehicle Base, '07+
Toyota Prius Vehicle Base, '09+
Toyota Camry Vehicle Base, '12+**

Revision

Rev.B

Form

INST-342

Printing Spec: PS-001



- You must read and follow all of these installation instructions. Failure to follow the installation instructions may result in serious bodily injury or death.
- Do not install or use the Vehicle Base in the area in which the airbag in the vehicle may be deployed. The installer and user of the Vehicle Base are responsible for installing and using the Vehicle Base outside the area in which an airbag may be deployed. (See Product Mounting Disclaimer Below)
- Keep these installation instructions with the product and readily available in the vehicle for future reference of other users of the product.
- Additional copies of the installation instructions can be obtained from Gamber-Johnson. If you need assistance or have any questions, call Gamber-Johnson at 1-800-456-6868.
- Do not remove warning label from product under any circumstances.

Begin by removing the front seat bolts of the front passenger's seat. Loosen the rear seat bolts of the same seat.

Tilt the seat back enough to slide the base under the front legs of the seat.

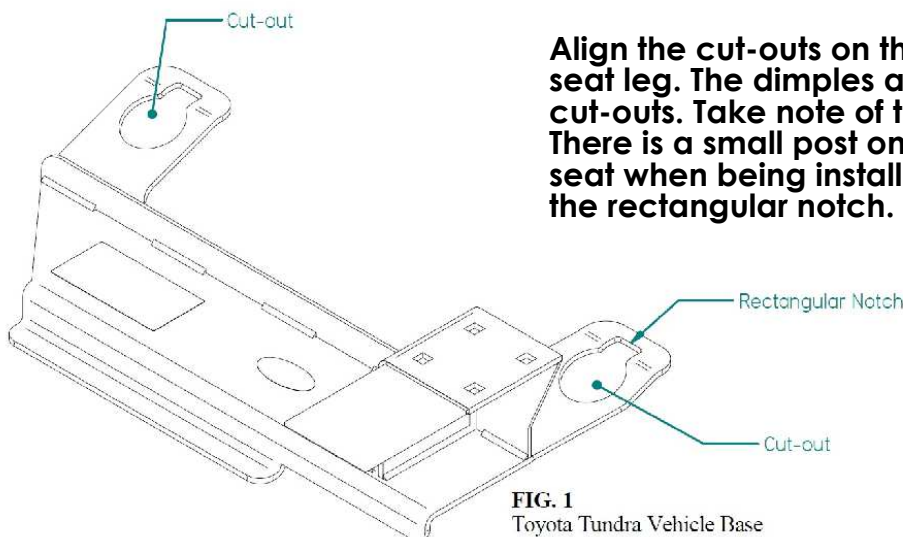

Align the cut-outs on the base under the dimple on the seat leg. The dimples are intended to rest centered in the cut-outs. Take note of the rectangular notch on each cut-out. There is a small post on each seat leg that helps to align the seat when being installed. This post is intended to insert into the rectangular notch.

FIG. 1
Toyota Tundra Vehicle Base

Product Mounting Disclaimer

Gamber-Johnson is not liable under any theory of contract or tort law for any loss, damage, personal injury, special, incidental or consequential damages for personal injury or other damage of any nature arising directly or indirectly as a result of the improper installation or use of its products in vehicle or any other application. In order to safely install and use Gamber-Johnson products full consideration of vehicle occupants, vehicle systems (i.e., the location of fuel lines, brakes lines, electrical, drive train or other systems), air-bags and other safety equipment is required. Gamber-Johnson specifically disclaims any responsibility for the improper use or installation of its products not consistent with the original vehicle manufactures specifications and recommendations, Gamber-Johnson product instruction sheets, or workmanship standards as endorsed through the Gamber-Johnson Certified Installer Program.

© Copyright 2013 Gamber-Johnson, LLC

If you need assistance or have questions, call Gamber-Johnson at 1-800-456-6868

4. Once the vehicle base is in position, replace the front seat bolts. Tighten the rear seat bolts. This completes the installation of the Vehicle Base. To complete the mounting system, see Gamber-Johnson's full line of Lower and Upper Pole assemblies, Motion Attachments, computer cradles and docking stations (all sold separately).

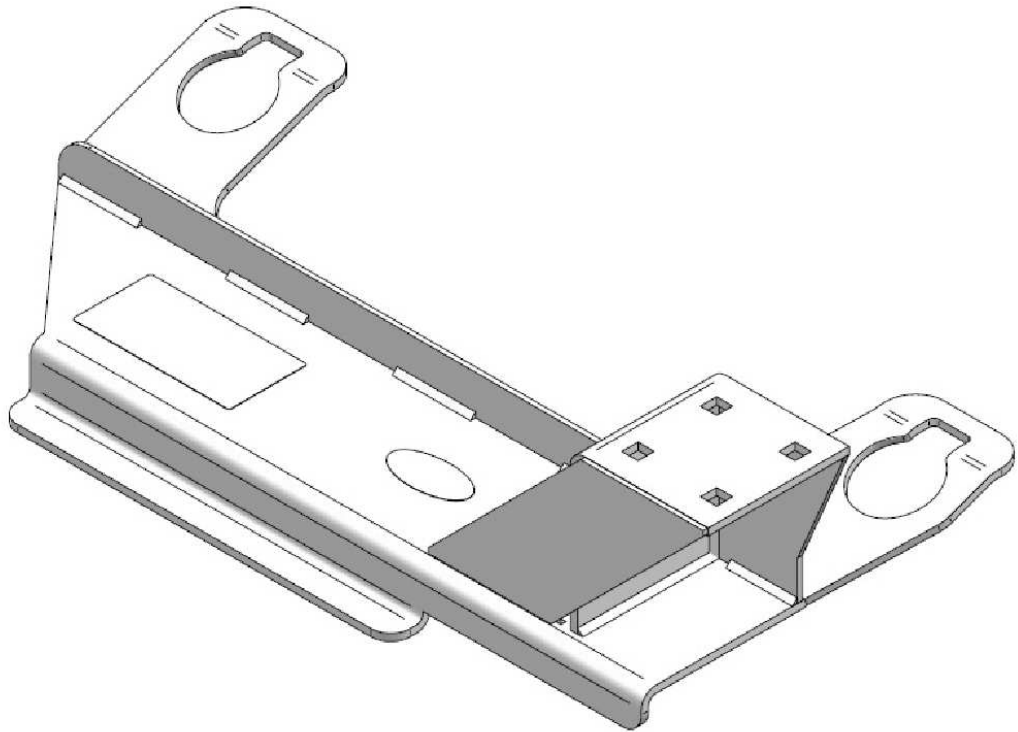

WARNING

- **The Vehicle Base should not be positioned in the area where the airbag may be deployed.**
- **DO NOT position the equipment in front of an airbag. Equipment positioned in front of an airbag may cause serious injury or death if an airbag is activated.**
- If installation of the equipment requires that the equipment be placed in front of an airbag, the airbag should be deactivated. In order to secure permission for deactivating the airbag, you must contact the National Highway Traffic Safety Administration at 1-800-424-9393 to gain permission to do so. If you have any questions or need assistance, call Gamber-Johnson at 1-800-456-6868.
- High speed vehicle turns may cause parts of the assembly to swivel, interfering with the driver or other equipment.