

# INSTALLATION INSTRUCTIONS

## Product

NotePad4 Accessories

## Revision

Rev B

## Form #

INST-176

NP-SCREEN, NP-CELL, NP-MIC, LED (7160-0098)

To assemble any or all of the options on this sheet, follow these first three steps:

1. Place the computer into the NotePad4 as if it were being installed.
2. Determine the location of the optional equipment and mark the location on the Notepad4 using tape or washable marker. (**IMPORTANT: Only install options on NotePad4 that DO NOT INTERFERE with the safe operation of the vehicle.**)
3. Remove computer

### Assembly of the NP-SCREEN:

1. The screen support is designed and assembled to attach to the left side of the NotePad4. If it is desirable to mount the unit to the right side of the NotePad4, skip to step 4.
2. Attach the screen support to NotePad4 using the two #8-32unc x 1/2" long socket head machine screws and flat washers that were provided in the hardware bag. **See Figure 1.** (All additional hardware in the hardware bag is provided for NotePad2 users - NotePad4 users should discard remaining hardware.)
3. Position the pivot screw near the pivot point of the screen. (The mounting bracket can be positioned away from the pivot point to eliminate interference with the computer ports.)
4. For right hand mounting of the screen support, minor disassembly and re-assembly of the product is required. Remove the pivot screw, hand knob, shoulder washer, and (2) flat plastic washers. **See Figure 2.** (The threads on the pivot screw are treated with re-usable thread-locking compound. Do not clean threads.)
5. Re-assemble the screen support as shown in Figure 2. The pivot arm must move freely when the hand knob is loosened. **DO NOT OVER TIGHTEN.** Go back to steps 2 & 3.

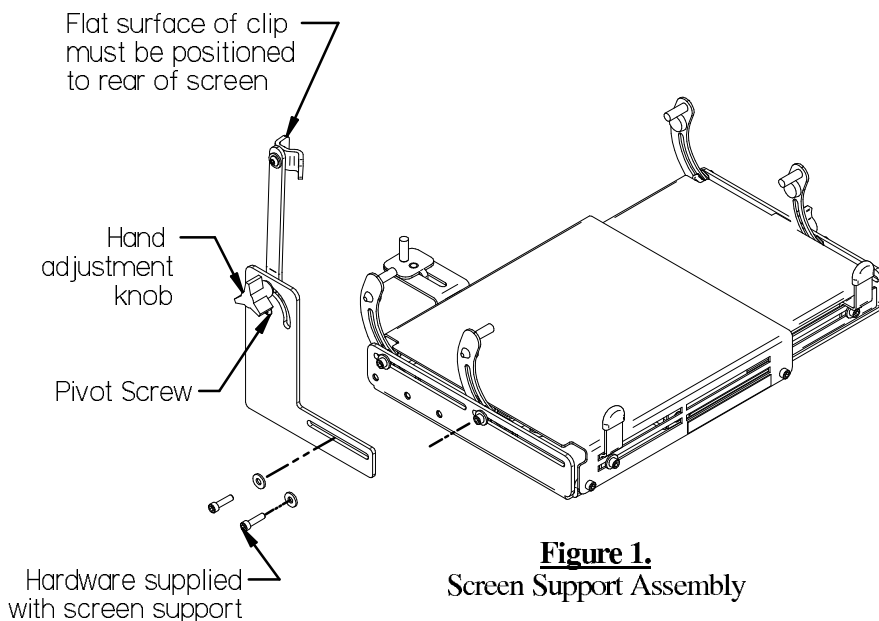

**Figure 1.**  
Screen Support Assembly

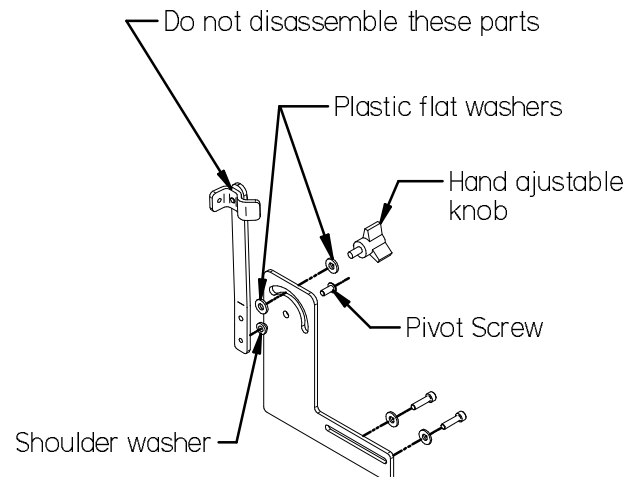

**Figure 2.**  
Screen Support for Right Hand Installation

### Assembly of the LED (7160-0098) See Figure 3 & Detail D

1. Insert the light bracket between the deck and side of the NotePad4. (LED Assembly can be mounted on either right or left side of the NotePad4.)
2. Attach the LED Assembly to the NotePad4 using the #8-32unc x 1/2" long socket head machine screws and flat washers that were provided in the hardware bag.
3. The light is powered using the red and black wires extending through the back of the bracket. The LED Assembly is designed to operate on 12volts DC. Connect the **RED wire to the POSITIVE** pole of the vehicle battery or distrubution box. It is recommended that a user-supplied fuse holder and 1 amp fuse be installed on red wire. Connect the **BLACK wire to the NEGATIVE** pole of the vehicle battery. .
4. Turn on LED by pressing the Activation Button on head of LED Assembly.  
LED has three light options: White, Red and White/Red. Press the Activation Button to toggle throught options. Hold the Activation Button down for approximately one second to turn LED off.

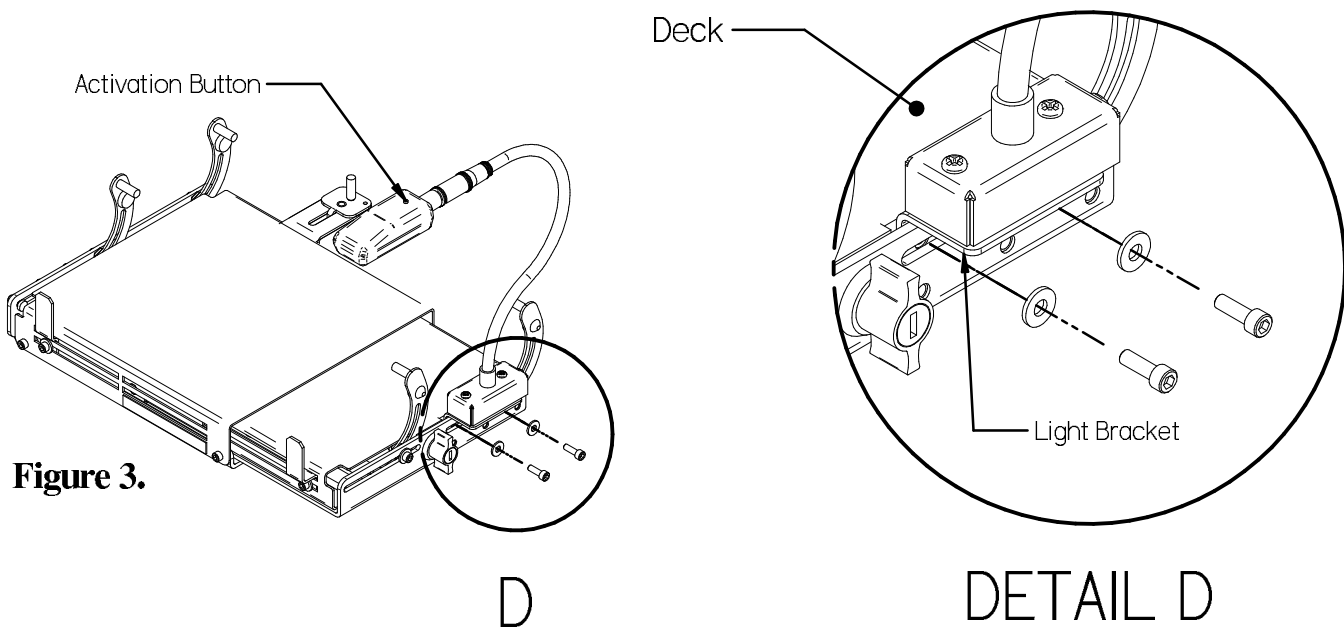

### Assembly of the NP-MIC: See Figure 4 & Detail B

1. Insert the mic bracket between the deck and the side of the NotePad4. (NP-MIC can be mounted on either right or left hand side of the NotePad4.)
2. Attach the NP-MIC to the NotePad4 using the #8-32unc x 1/2" long socket head machine screws and flat washers that were provided in the hardware bag.

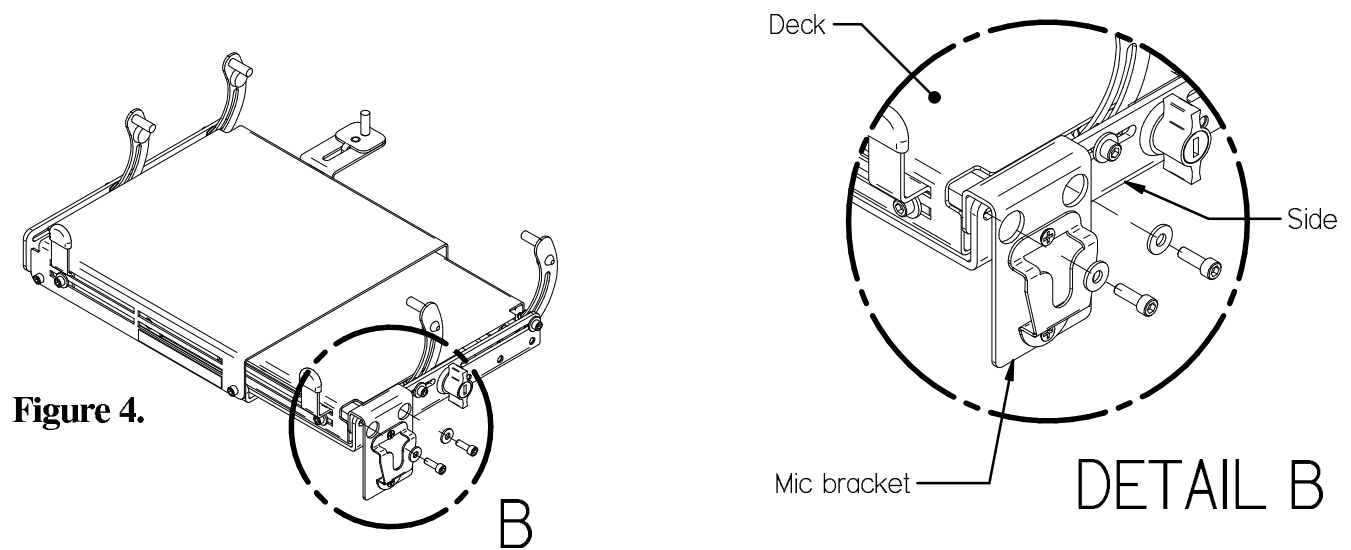

## **Assembly of the NP-Cell: See Figure 5 & Detail C**

1. Insert the cell phone bracket between the deck and the side of the NotePad4. (NP-CELL can be mounted to either side of the NotePad4.)
2. Attach the Cell phone bracket to the NotePad4 using the #8-32unc x 1/2" long socket head machine screws and flat washers that were provided in the hardware bag.

**Figure 5.**

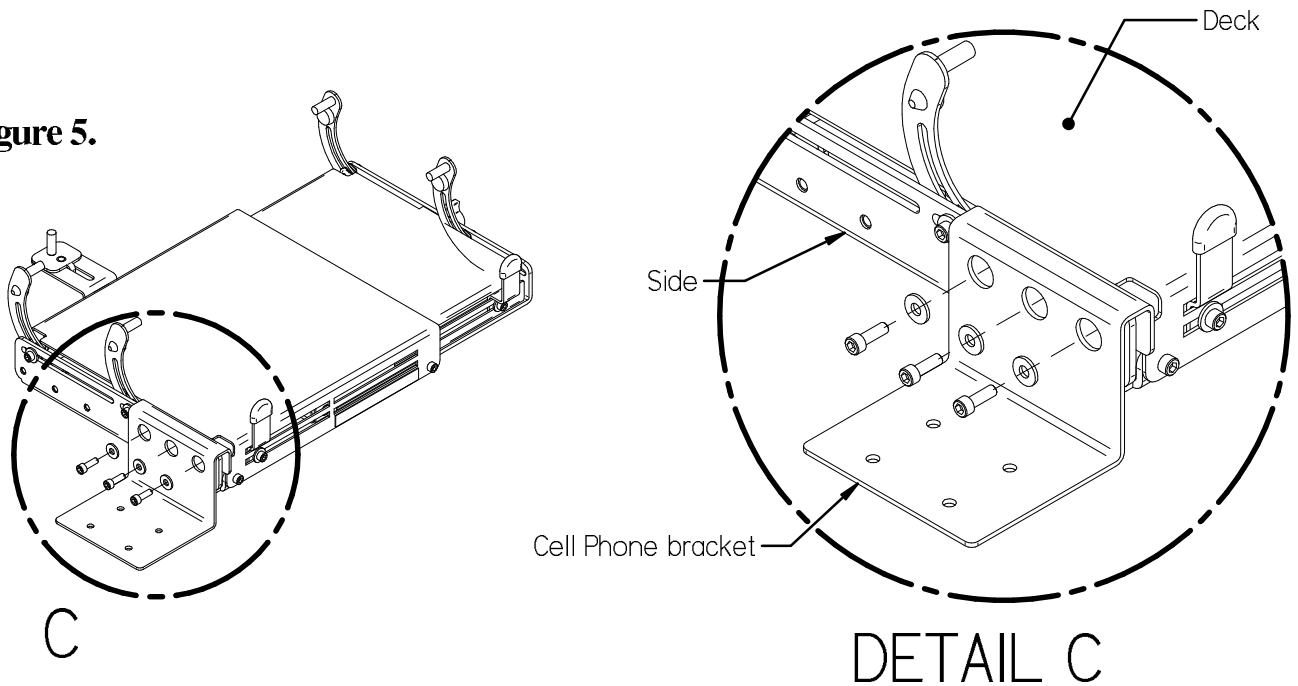

### **Product Mounting Disclaimer**

Gamber-Johnson is not liable under any theory of contract or tort law for any loss, damage, personal injury, special, incidental or consequential damages for personal injury or other damage of any nature arising directly or indirectly as a result of the improper installation or use of its products in vehicle or any other application. In order to safely install and use Gamber-Johnson products full consideration of vehicle occupants, vehicle systems (i.e., the location of fuel lines, brakes lines, electrical, drive train or other systems), air-bags and other safety equipment is required. Gamber-Johnson specifically disclaims any responsibility for the improper use or installation of its products not consistent with the original vehicle manufactures specifications and recommendations, Gamber-Johnson product instruction sheets, or workmanship standards as endorsed through the Gamber-Johnson Certified Installer Program.

© copyright 2012 Gamber-Johnson, LLC

If you need assistance or have questions, call Gamber-Johnson at 1-800-456-6868