

# INSTALLATION MANUAL

## PSD-SHA / PSD-SHB / PSD-SHP

### Step 1

Open the box and remove all components.

### Step 2

Slide the shelf over the poles, select the desired height and lock the height by tightening the four (4) Allen head screws using the hex key.

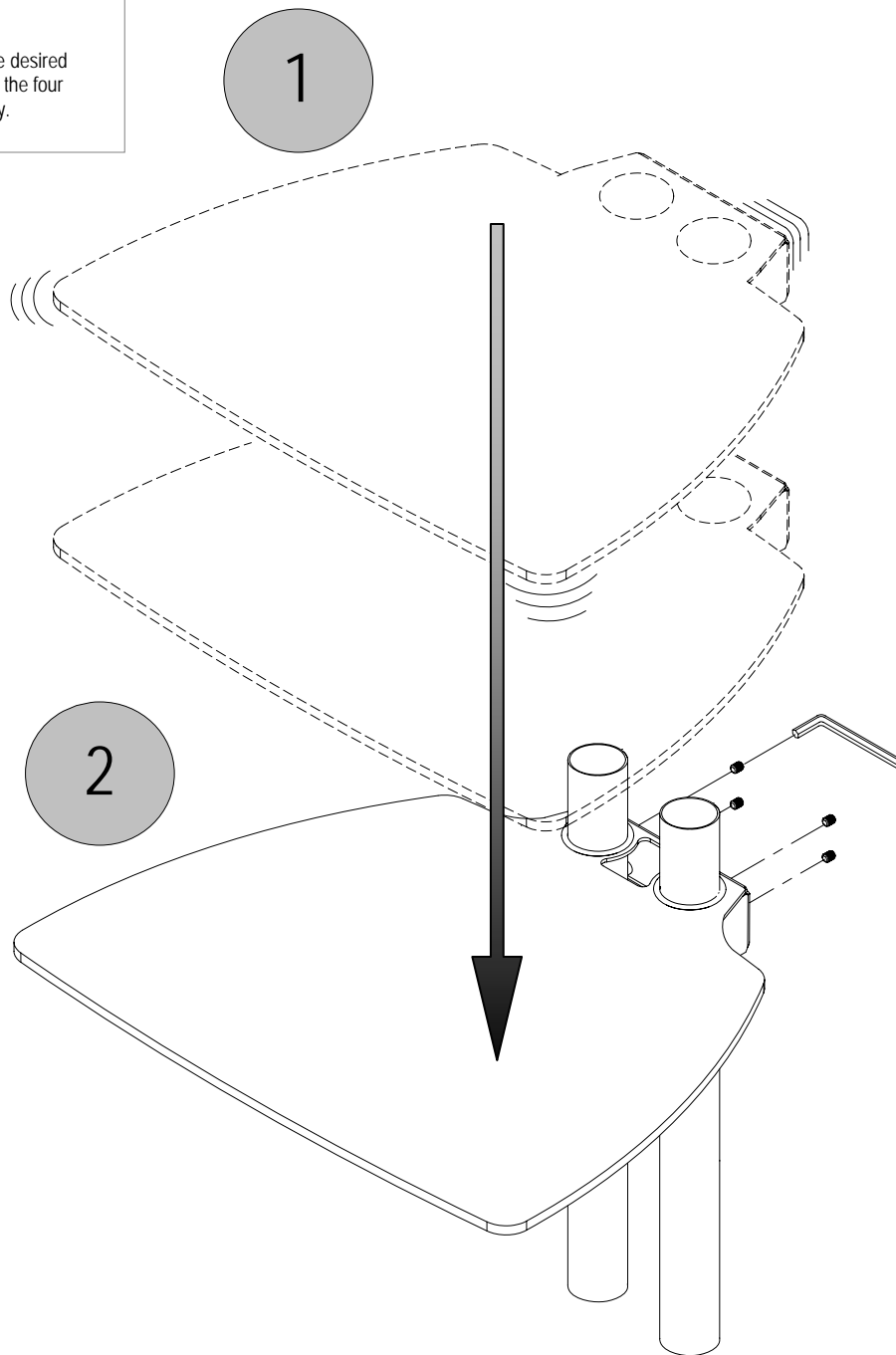

 **PREMIER  
MOUNTS™**  
The original holding company

3130 E. Miraloma Ave. Anaheim, CA 92806 Phone: 800 368-9700 Fax: 800 832-4888

[www.mounts.com](http://www.mounts.com)